

T.4S.,R.40E.,W.M.

14

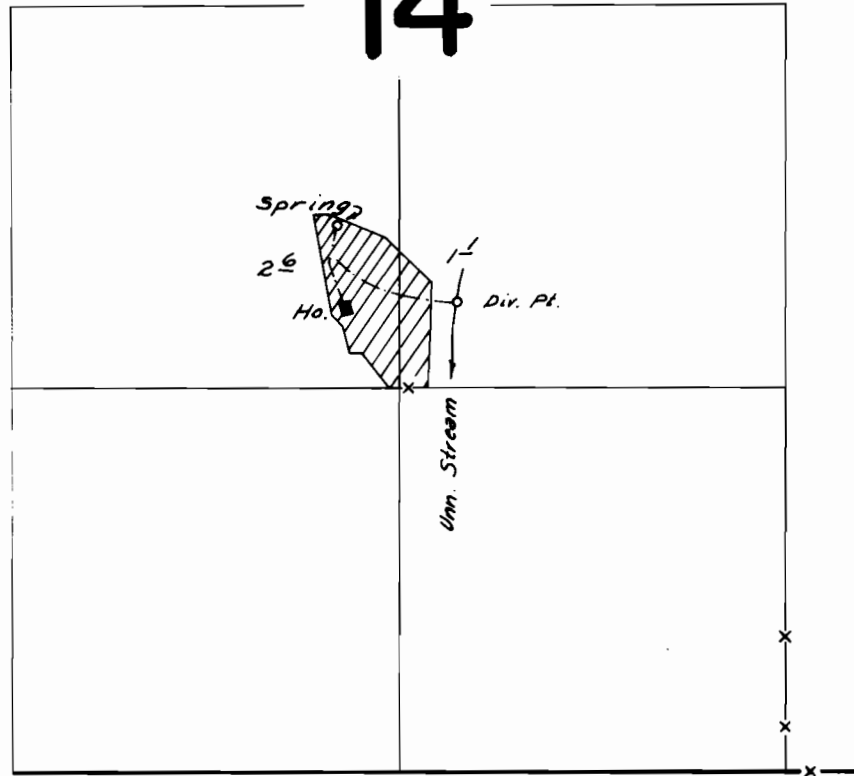

Spring Loc.: 1880' N. & 210' W. from $S\frac{1}{4}$ Cor. Sec 14
Div. Pt. Loc.: 1610' N. & 190' E. from $S\frac{1}{4}$ Cor. Sec 14

SCALE 1" = 660'

FINAL PROOF SURVEY
UNDER

Application No. 49110 Permit No. 36831
IN NAME OF

M.C. & Virginia E. Pyatt

Surveyed Sept 23, 1976, by D.M. Norby