

# T.28S. R.4W.W.M.

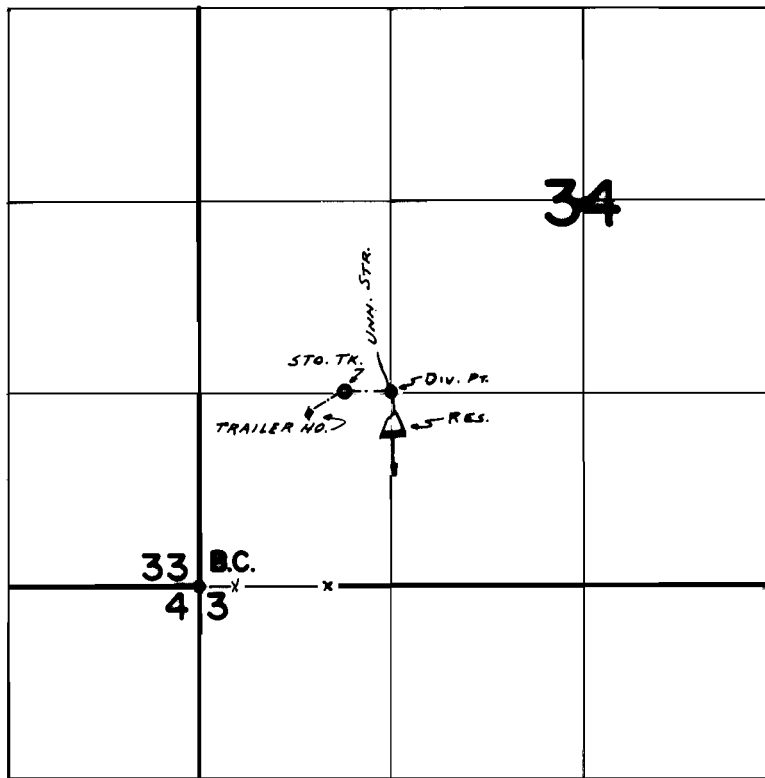

*DIV. PK - 1320' N of 1320' E FROM SW COR. SEC. 34*

## FINAL PROOF SURVEY UNDER

Application No. 43580.... Permit No. 32589....  
IN NAME OF

Lawrence J. Thomas L. & John R. Patterson

Surveyed 5-8 1972., by R.G. MUCKEN.....