

T.18S.,R.2W.,W.M.

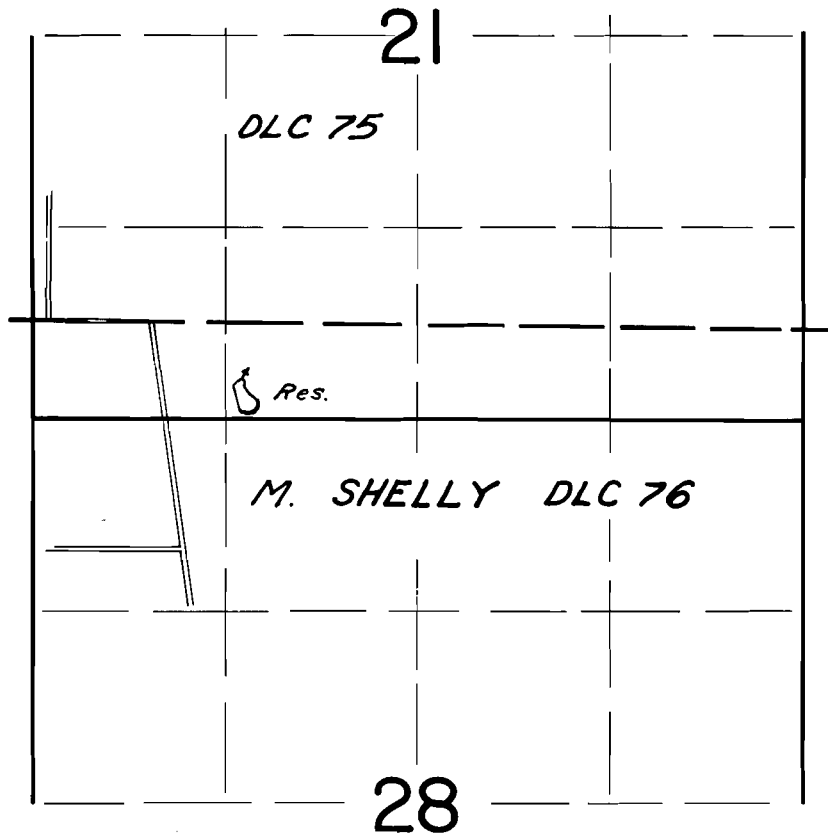

RES. LOC: 150' N. & 1450' E. from SW Cor. Sec. 21

FINAL PROOF SURVEY
UNDER

Application No. R-52462 52667 Permit No. R-6321 39460
IN NAME OF

William W. & Jane W. Berg

Surveyed Oct. 28, 1976, by D. M. Norby