

# T.9S.,R.5W.,W.M.

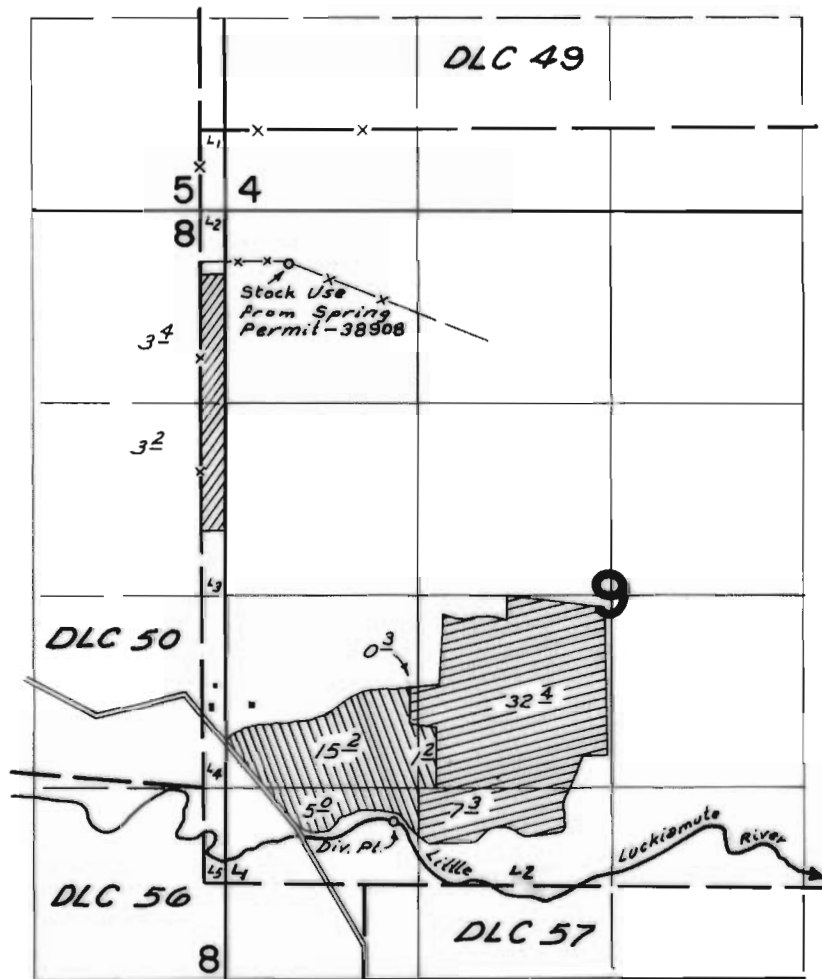

Spring Loc.: 930' S. & 610' E. from SW Cor. DLC 49

Div. Pt. Loc.: 1100' N. & 1140' E. from SW Cor.  
Sec. 9

 Transfer 2997

 Transfer 2998

 Permit 40117

## FINAL PROOF SURVEY UNDER

Transfer No's. 2997 & 2998  
51581 38908

Application No. 51611 Permit No. 40117  
IN NAME OF

Clare R. Millhouser

Surveyed May 17, 1976, by C. R. King

Aug 12 1976 "