

G 6439
46626

T. 4N. R. 28E. W.M.

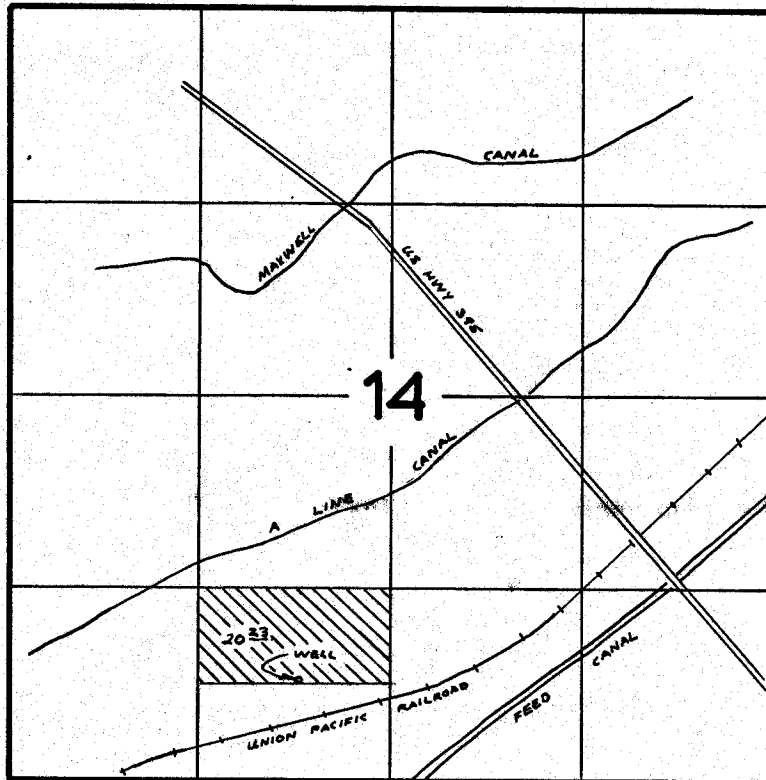

WELL LOCATED: 660' N. & 660' W. FROM SOUTH 1/4 CORNER SEC 14.

FINAL PROOF SURVEY
UNDER

Application No. G. 6917..... Permit No. G6439.....
IN NAME OF

.....HERMISTON CEMETERY DISTRICT NO. 8.....

Surveyed .NOV. 29. 1977., by ..R. BARWIN.....