

T.6S.R.2W.W.M.

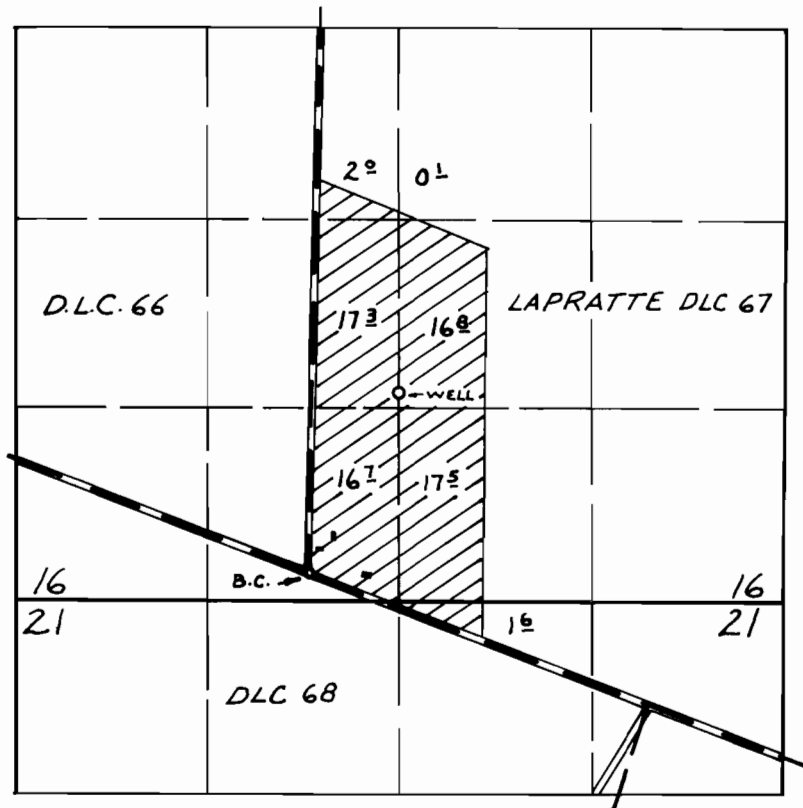

WELL LOC: 1240' N. & 620' E. FROM S.W. COR. D.L.C. 67

FINAL PROOF SURVEY UNDER

Application No. G-6338 Permit No. G-5943
IN NAME OF

DONALD W. BASSETT

Surveyed AUG. 3, 1976, by R. MUCKEN