

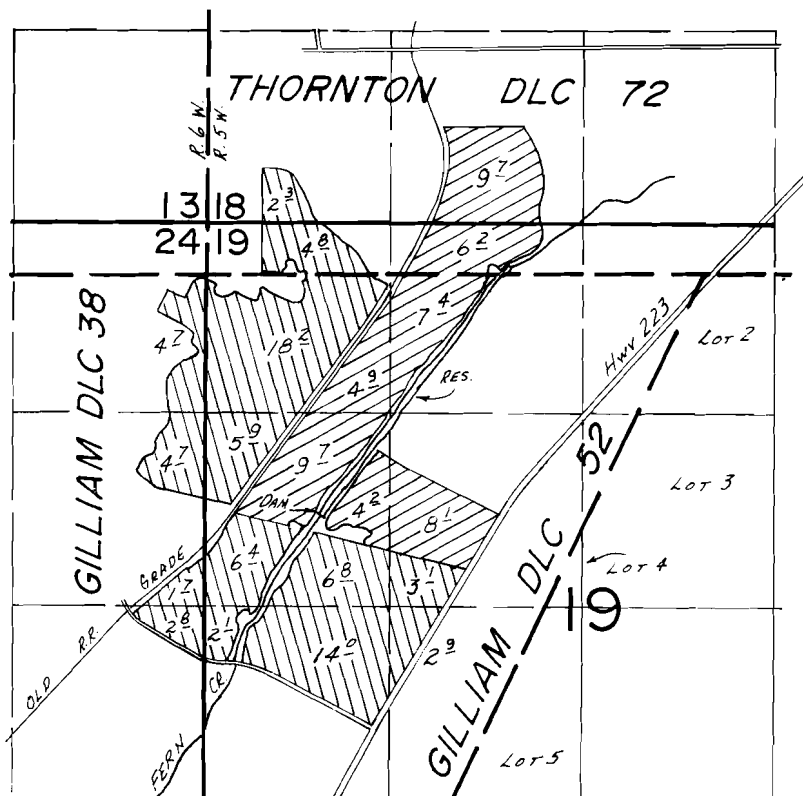

T.8S., R.5&6W., W.M.



Div. Pt. LOC.: 670' N. & 800' E. FROM N 1/4 COR. SEC. 19.

SCALE: 1" = 1320'

FINAL PROOF SURVEY UNDER

54419	40807	
R-49036	R-5787	
Application No. 49037	Permit No. 35828	

IN NAME OF

MR. & MRS. SAM OBERG

Surveyed June 10, 1976, by R.G. MUCKEN
Sept. 10, 1981 L.M. TOLL