

# T. 6 S., R. 4 W., W.M.

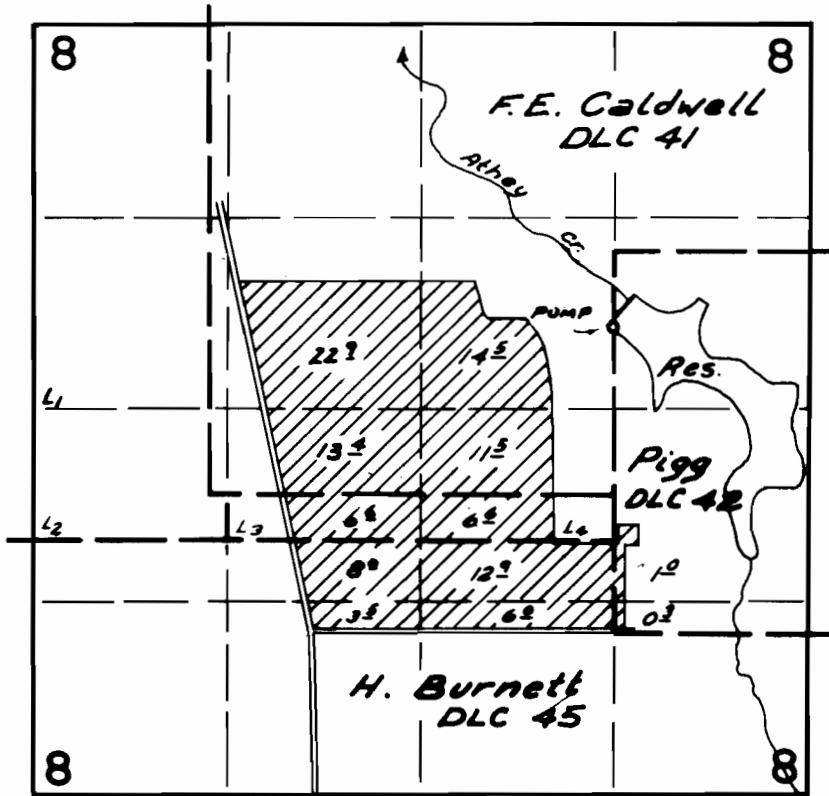

DIV. PT. LOC.: 350' S. & 100' E. FROM N.W. COR. DLC 42

## FINAL PROOF SURVEY UNDER

Application No. 53885 Permit No. 40206  
IN NAME OF

Marjorie N. Stewart

Surveyed Oct 22, 1976 by D.M. Norby