

T.5N. R.4W. W.M.

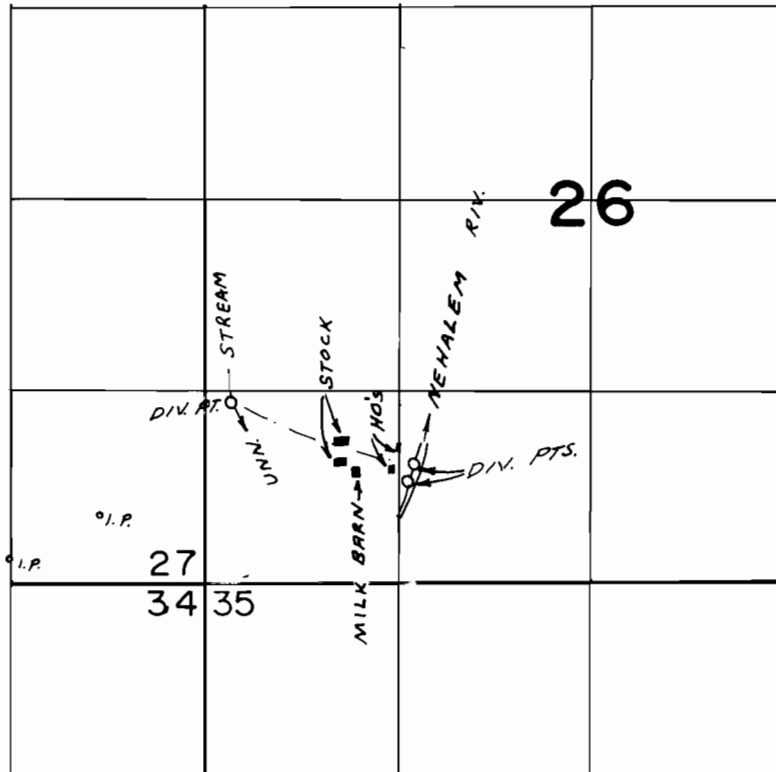

UNN. STREAM DIV. PT LOC. 1250' N. & 180' E., N. DIV. PT. LOC. 820' N. & 1430' E., S. DIV. PT. LOC. 700' N. & 1390' E., ALL FROM THE SW CORNER SECTION 26.

FINAL PROOF SURVEY
UNDER

Application No. 51904..... 51905..... Permit No. 39157..... 39158.....
IN NAME OF

.....LOREN ELLIS JR.....

Surveyed MAY 25 1976., by L.H. NUNN.....