

# T.3N. R.2W. W.M.

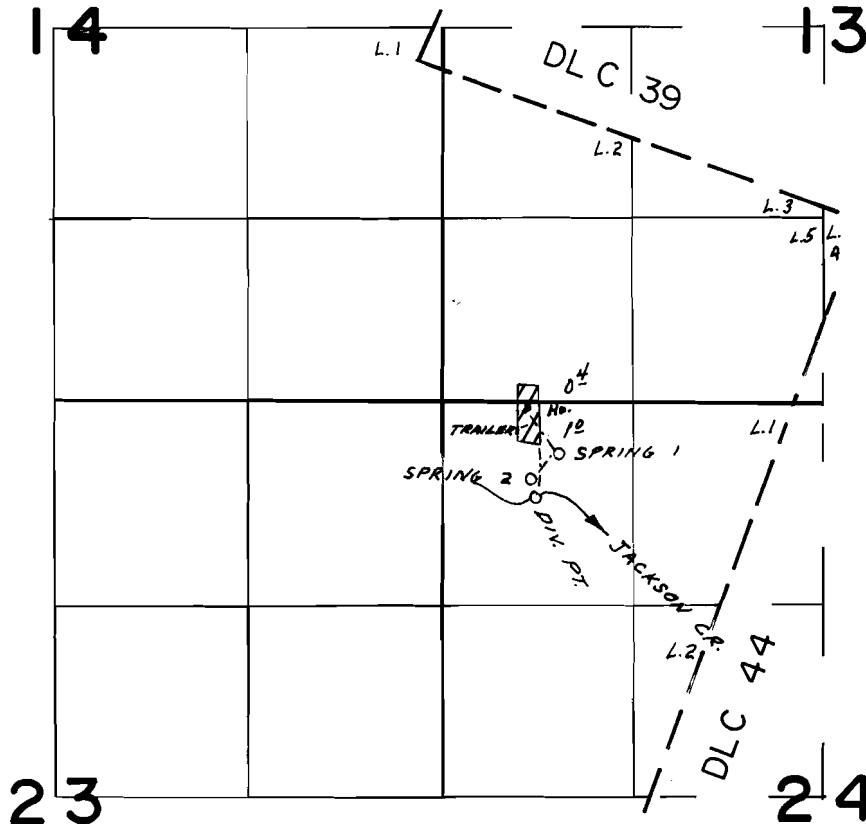

DIV. PT. LOC. 640'S. & 640'E., SPRING 1 LOC. 350'S. & 790'E., SPRING 2 LOC. 540'S. & 600'E FROM NW COR. SEC. 24

## FINAL PROOF SURVEY UNDER

Application No. 53362.... Permit No. 39589....  
IN NAME OF

.....JACK J. CALLAHAN.....

Surveyed MAY 28, 1976., by L.H. NUNN.....