

G-4051  
46772

# T.1N.R.20&21E.W.M.

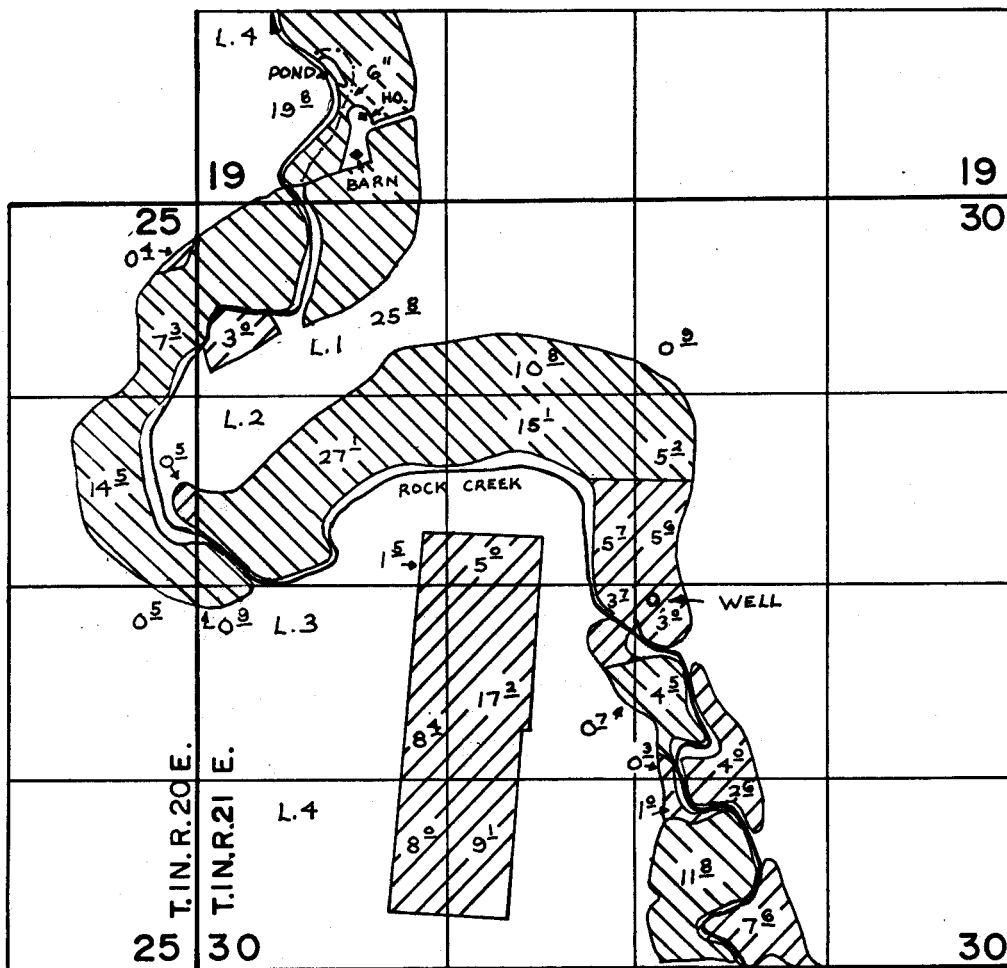

WELL LOC. - 100' S. & 100' E. FROM CENTER OF SEC. 30

-  PRIMARY
-  SUPPLEMENTAL

## FINAL PROOF SURVEY UNDER

Application No. G-4481 Permit No. G-4051  
IN NAME OF

A. DAVID & PEGGY S. CHILDS

Surveyed July 22 1976, by R. G. Mucken