

G 5285
46916

T.2N.,R.33E.,W.M.

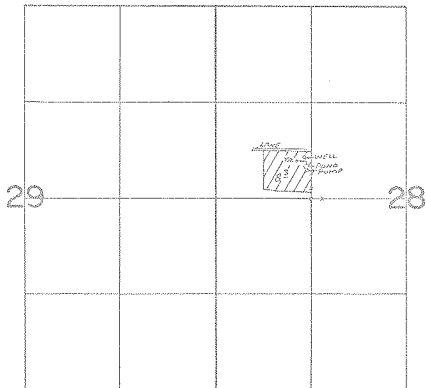

Well loc: 570' N AND 90' W FROM SE COR SW 1/4 NW 1/4 Sec 28

FINAL PROOF SURVEY
UNDER

Application No. ..G:5390 Permit No. ..G:5285.
IN NAME OF

.....BERNARD DUBY.....

Surveyed APRIL 13, 1976, by L. TALL.....