

G 5888
46820

T. 4 N., R. 28 E., W.M.

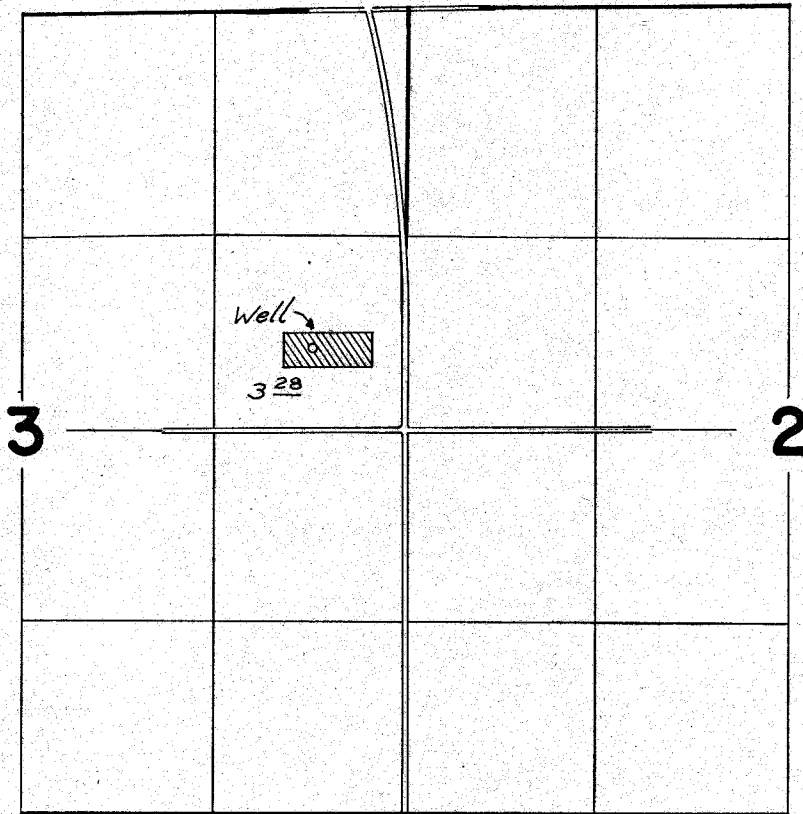

Well Loc.: 660' N. & 640' W. from E. $\frac{1}{4}$ Cor. Sec. 3.

FINAL PROOF SURVEY UNDER

Application No. G-6243 Permit No. G-5888
IN NAME OF

V. D. & G. Rhinhart

Surveyed July 29, 1976, by L. H. Nunn

NZ-IP-121 *LCB*