

T.6N.,R.35E.,W.M.

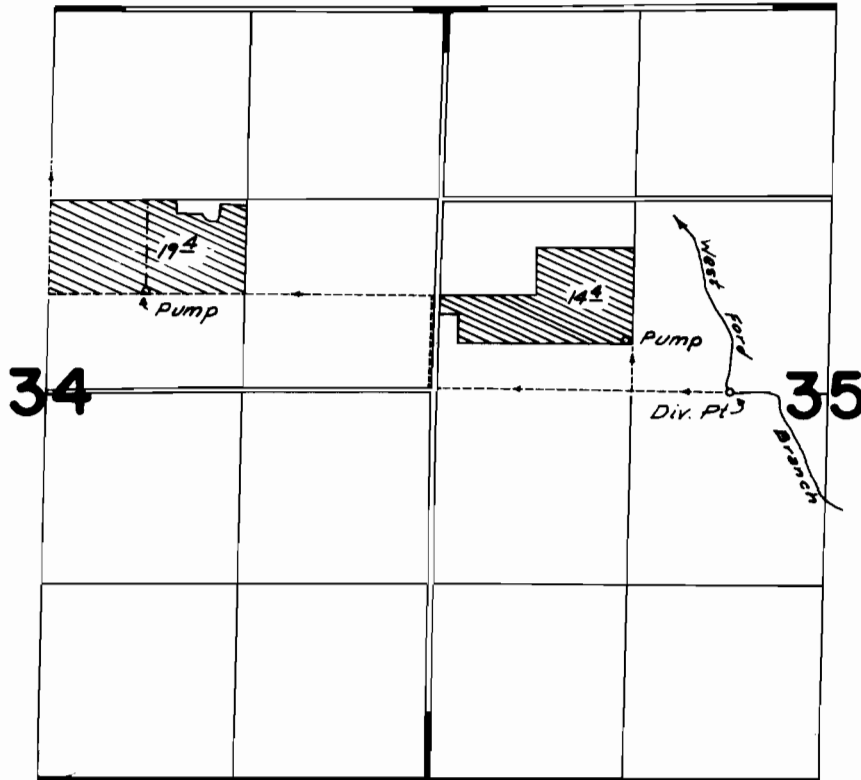

Div. Pt. Loc.: 2000' E. from W. $\frac{1}{4}$ Cor. Sec. 35

FINAL PROOF SURVEY UNDER

Application No. 52105 Permit No. 39255
IN NAME OF

Earl E. & Lorraine Brown

Surveyed Apr. 7, 1976 by C. R. King

NZ-5MM-69 *dlB*