

G-645 -
 27829 -
 25977 -
 G-338 -
 G-646 -
 G-647 -
 G-648 -

T.2N.R.13E.W.M.

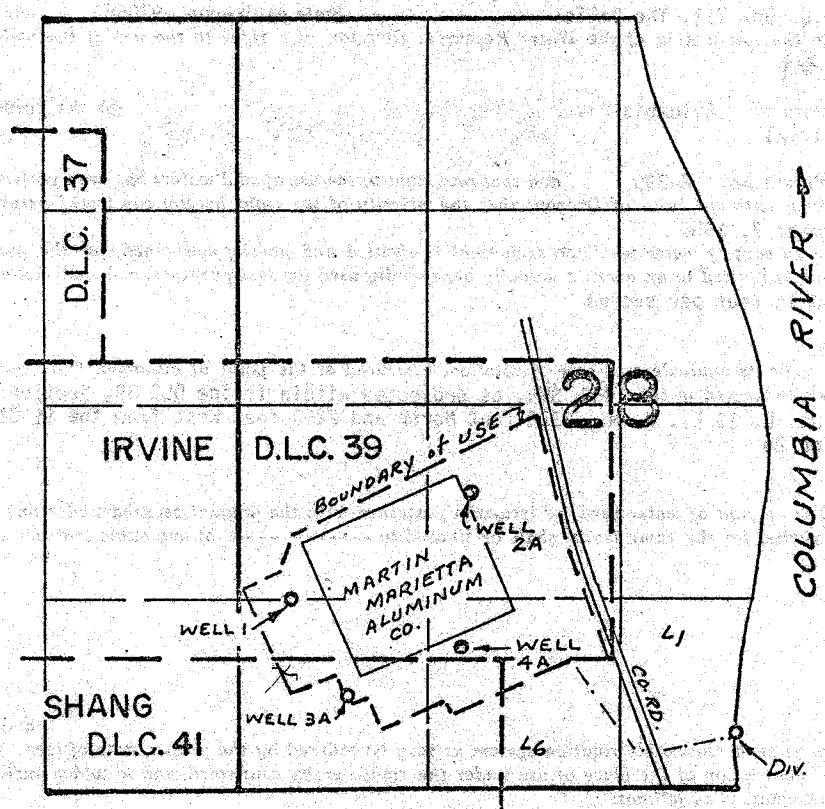

DIV. PTS. LOC: RIVER - 380' N. & 780' E.
 WELL 1 - 1320' N & 2260' W,
 WELL 2A - 2020' N & 1030' W,
 WELL 3A - 680' N & 1880' W,
 WELL 4A - 970' N & 1080' W, ALL FROM S 1/4
 COR. SEC. 28

FINAL PROOF SURVEY

| | |
|-------|-------|
| 37388 | 27829 |
| 32900 | 25977 |
| G-471 | G-338 |
| G-734 | G-645 |
| G-735 | G-646 |
| G-736 | G-647 |
| G-737 | G-648 |

Application No. G-737..... Permit No. G-648.....
 IN NAME OF

MARTIN MARIETTA ALUMINUM CO.

Surveyed MAR. 23 1978, by TOM PAUL