

G-645 -
 27829
 25977
 G-338
 G-646 -
 G-647 -
 G-648 -

T.2N.R.13E.W.M.

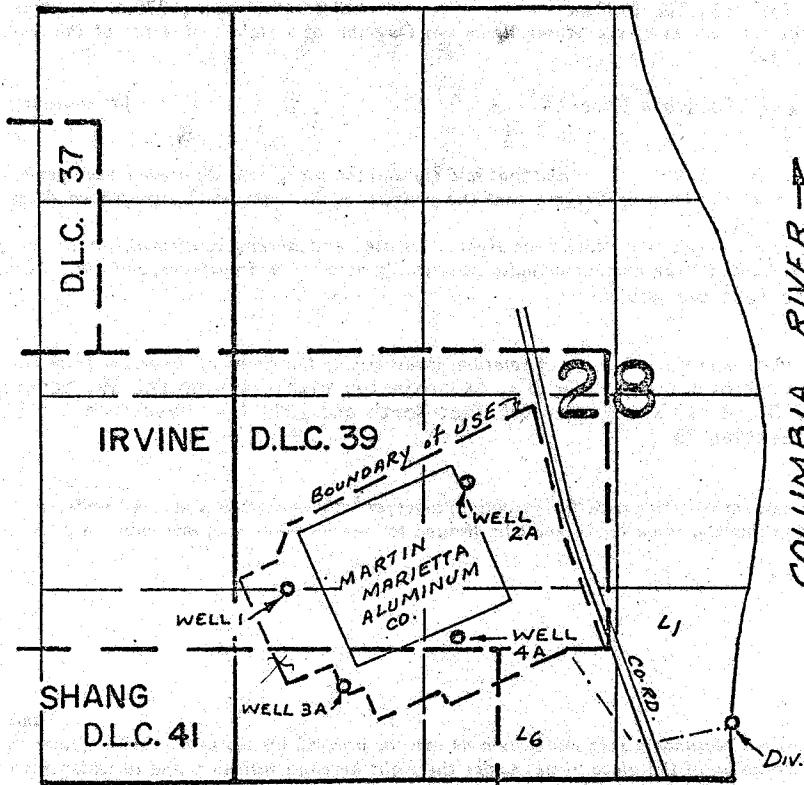

DIV. PTS. LOC: RIVER - 380' N. & 780' E.
 WELL 1 - 1320' N & 2260' W,
 WELL 2A - 2020' N & 1030' W,
 WELL 3A - 640' N & 1880' W,
 WELL 4A - 970' N & 1080' W, ALL FROM S 1/4
 COR. SEC. 28

FINAL PROOF SURVEY

37388	27829
32900	25977
G-471	G-338
G-734	G-645
G-735	G-646
G-736	G-647
G-737	G-648

Application No. G-737..... Permit No. G-648.....
 IN NAME OF

MARTIN MARIETTA ALUMINUM CO.

Surveyed MAR. 23 1978, by TOM PAUL