

TOWNSHIP 1 N., RANGE 20 E

4

3

9

10

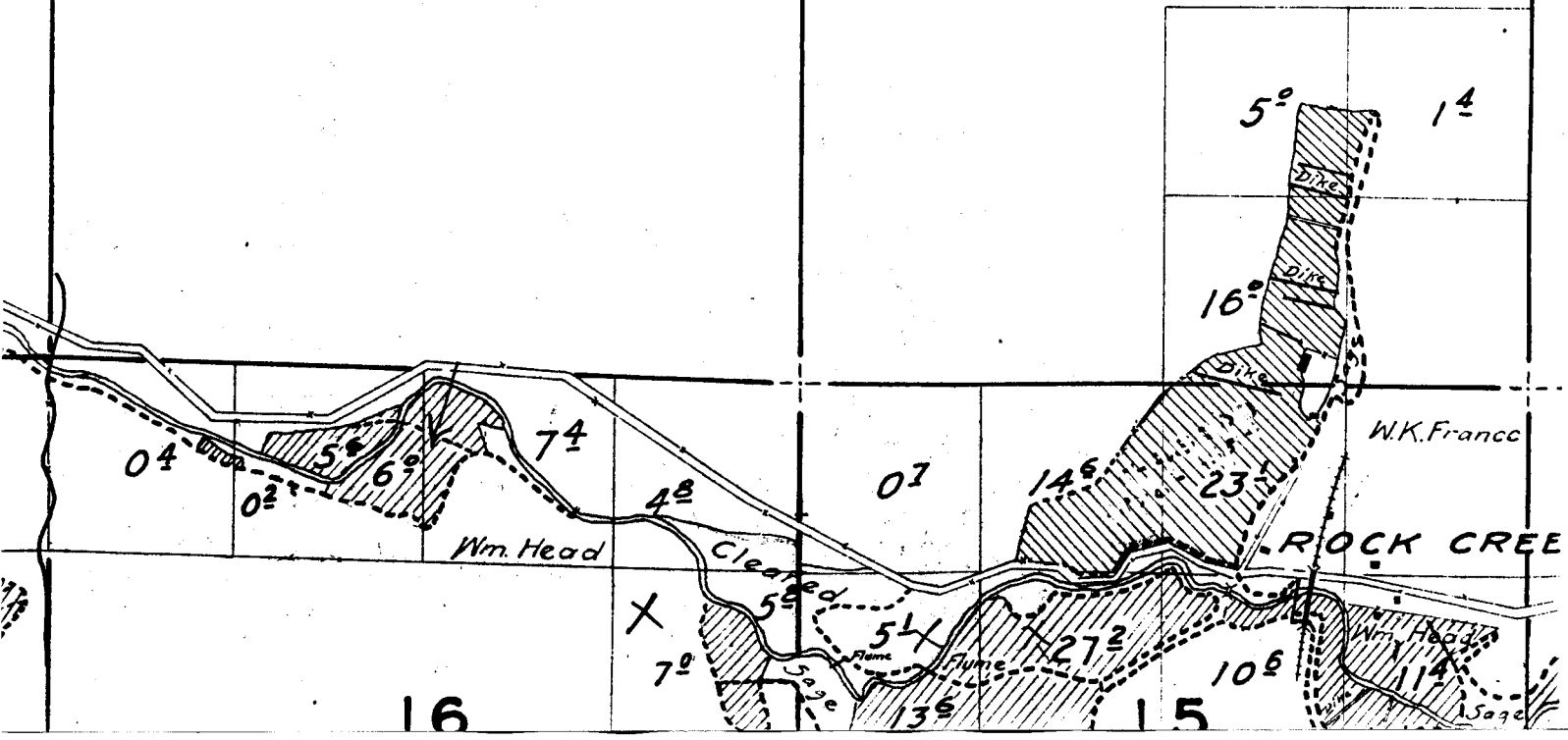

16

15

ANGE 20 E.

4-2-1

3

2

1

10

11

12

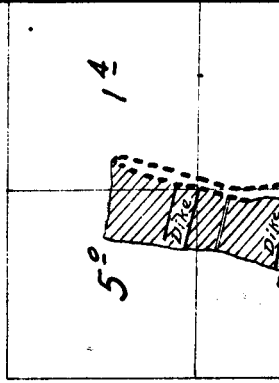

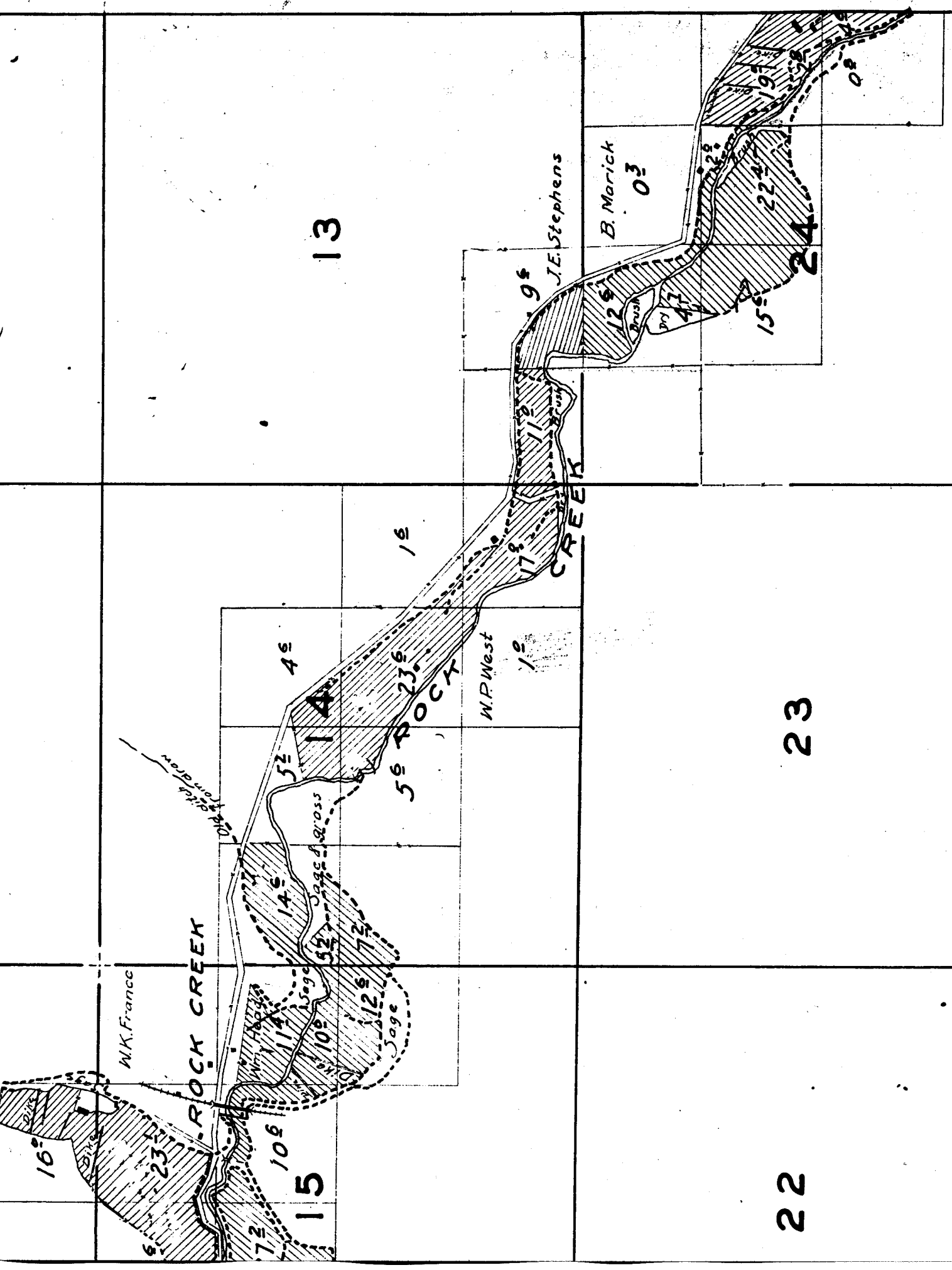

13

J.E. Stephens

B. Marick

03

9s

12s

19s

22s

24s

27s

30s

33s

36s

39s

42s

45s

48s

51s

54s

57s

60s

63s

66s

69s

72s

75s

78s

81s

4s

14

1s

23s

5s

52s

10s

11s

W.P. West

1s

W.K. France

ROCK CREEK

15

23

22

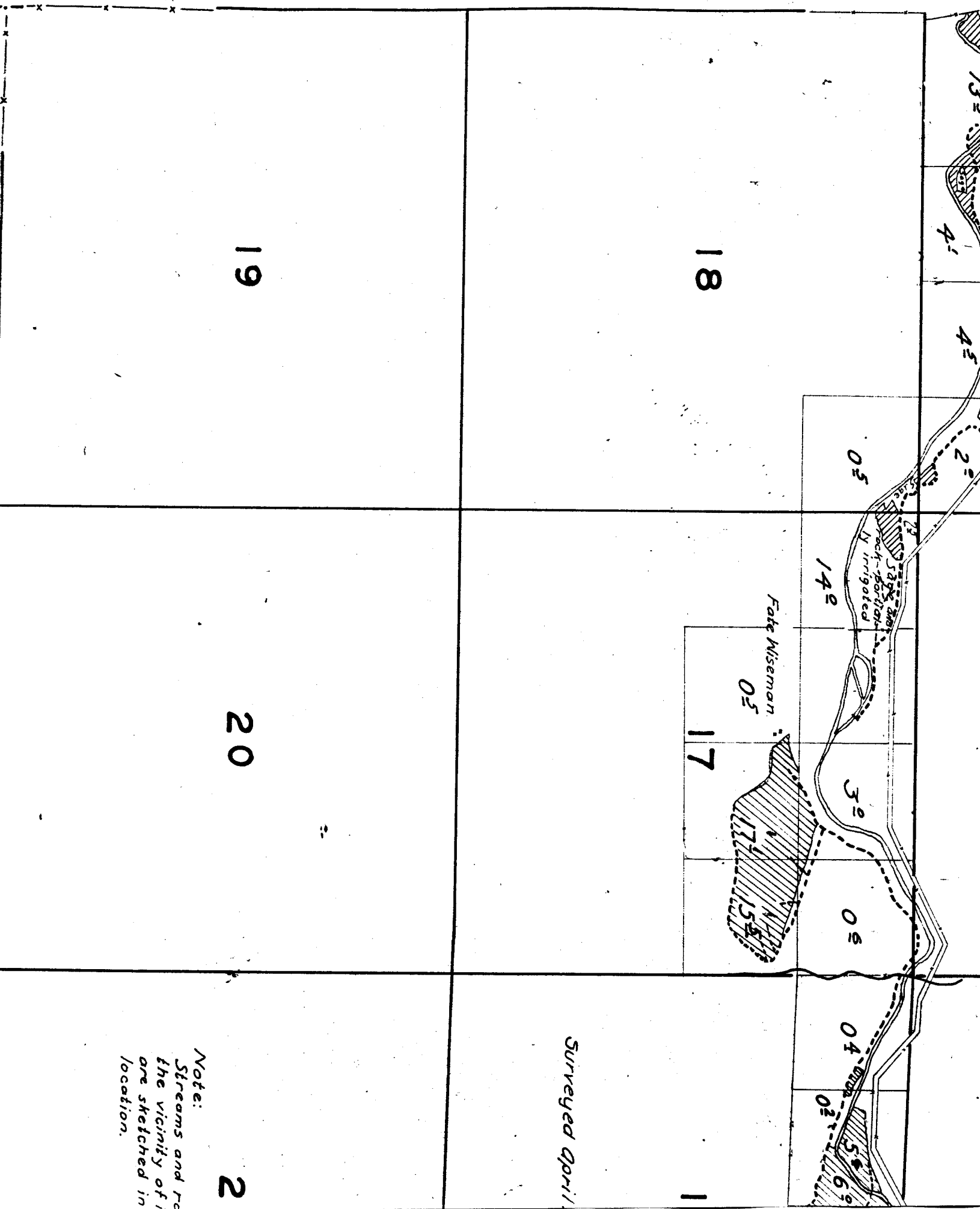

TOWNS

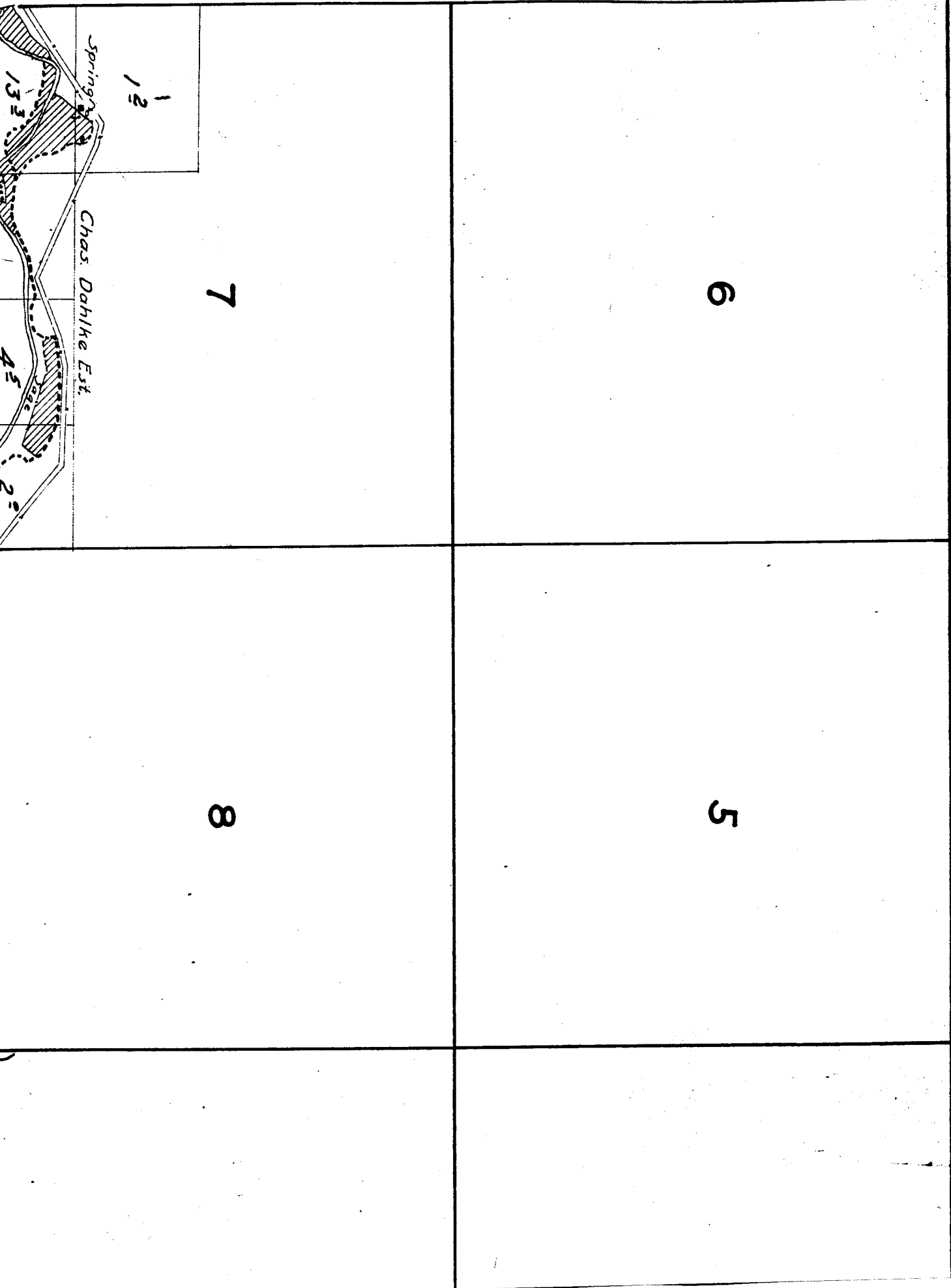

23

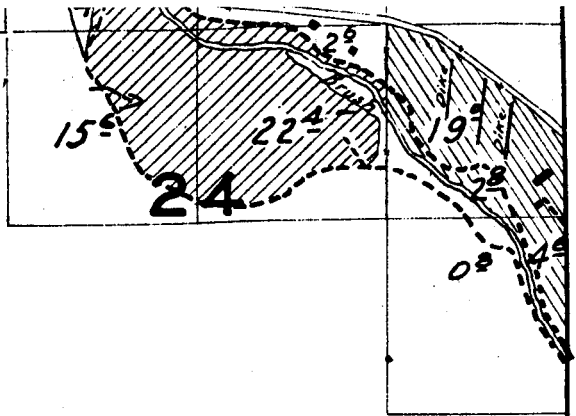

26

25



35

36

19

20

30

29

102
old ditches
JOHN DAY RIVER

31

32

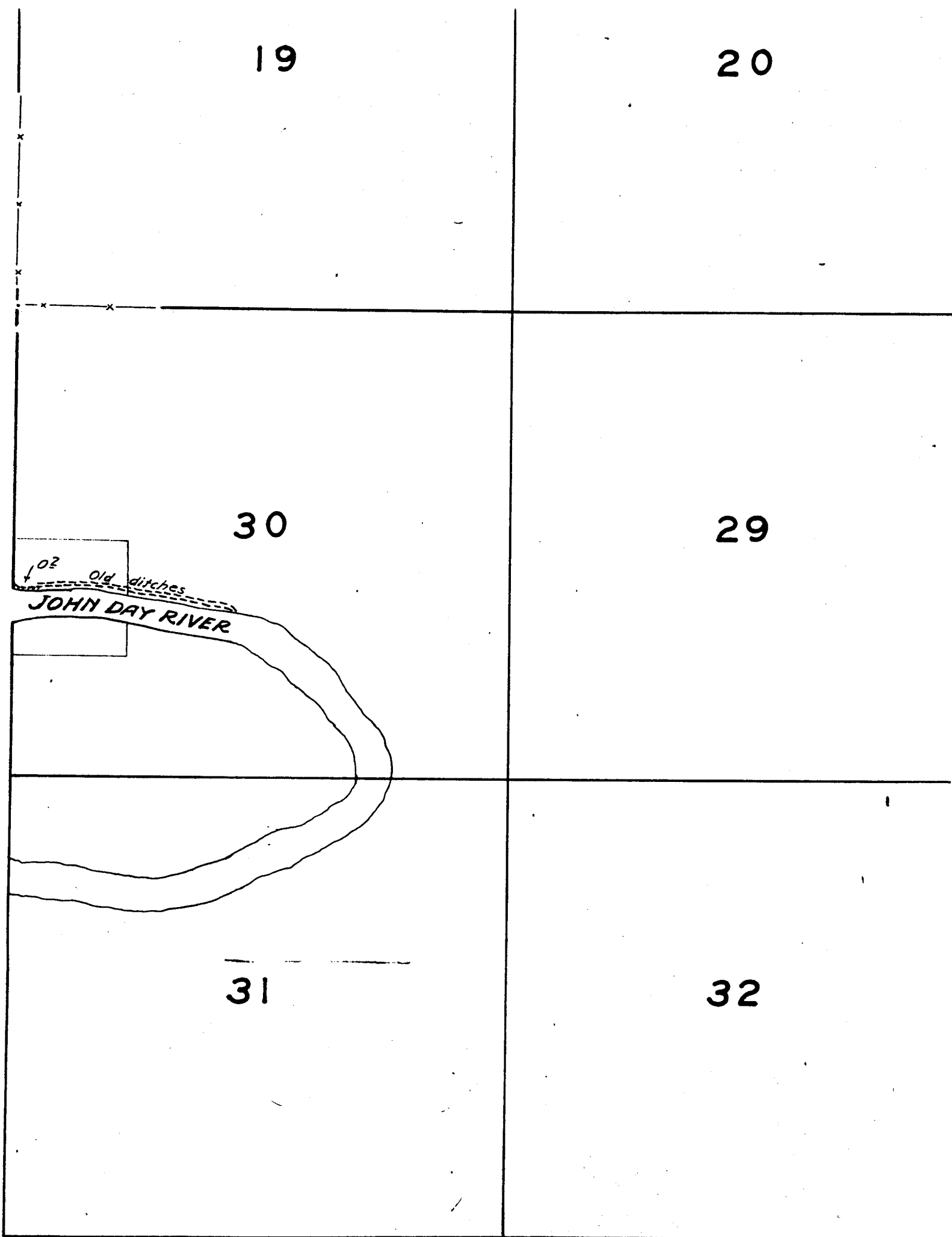

28

27

33

34

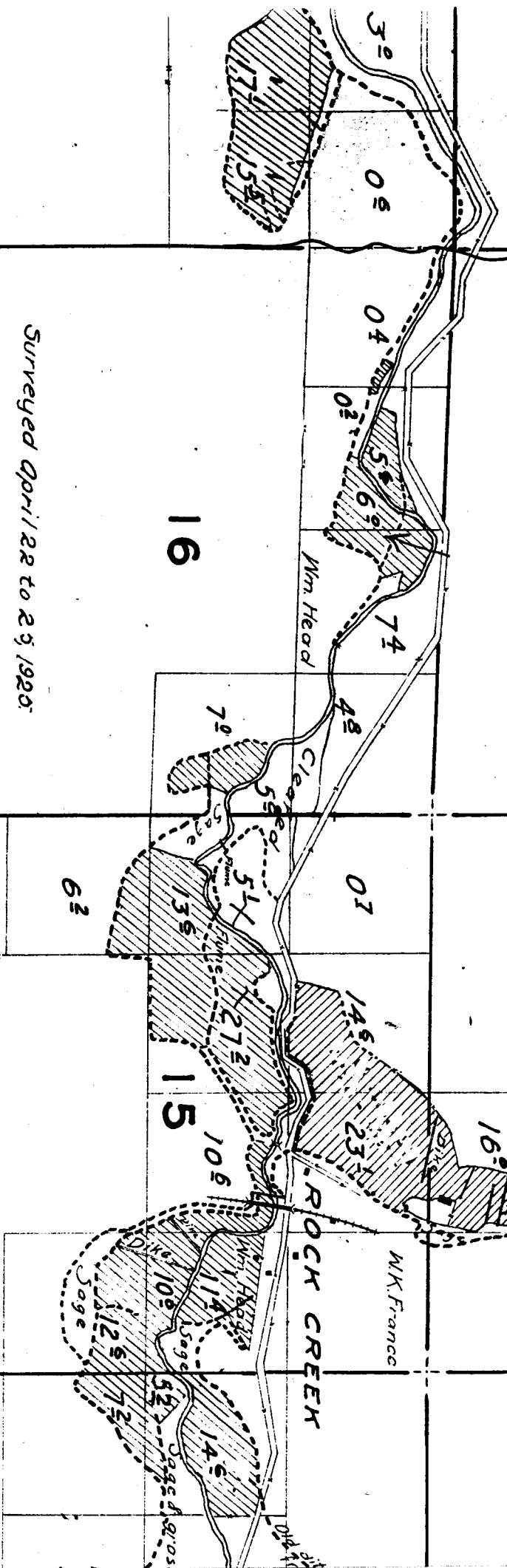

Surveyed April 22 to 25, 1920.

Note:
Streams and roads, except in
the vicinity of irrigated land,
are sketched in approximate
location.

21

22