

46871

T.38 & 39S. R.11 1/2 E. W.M.

Buck Creek: Yonna Valley wells

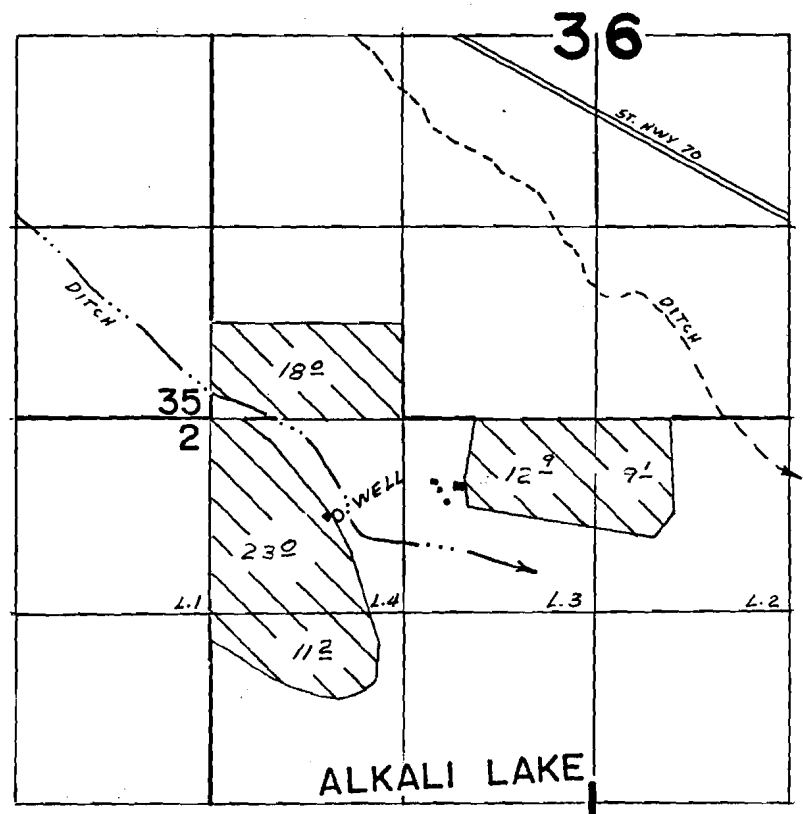

WELL LOC. 660' S. & 880' E. FROM NW COR. SEC. 1

**FINAL PROOF SURVEY**  
UNDER

Application No. G-5357... Permit No. G-5295...  
IN NAME OF

MR. & MRS. JAMES JAY

Surveyed APR. 23. 1976, by L.H. NUNN