

T.39S. R.12E. W.M.

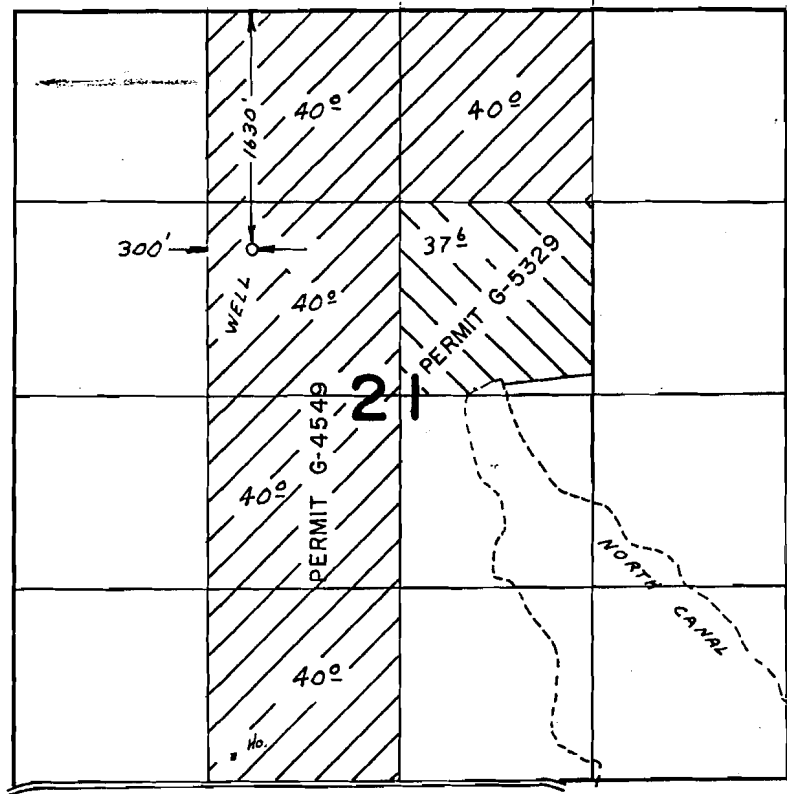

Foot River wells

FINAL PROOF SURVEY UNDER

G-4907 G-4549
 Application No. G-6171 Permit No. G-5329
 IN NAME OF

RAYMOND N. & MYRTLE J. EVATT

Surveyed APR. 23. 1976, by L.H. NUNN.....