

T.17S. R.8W. W.M.

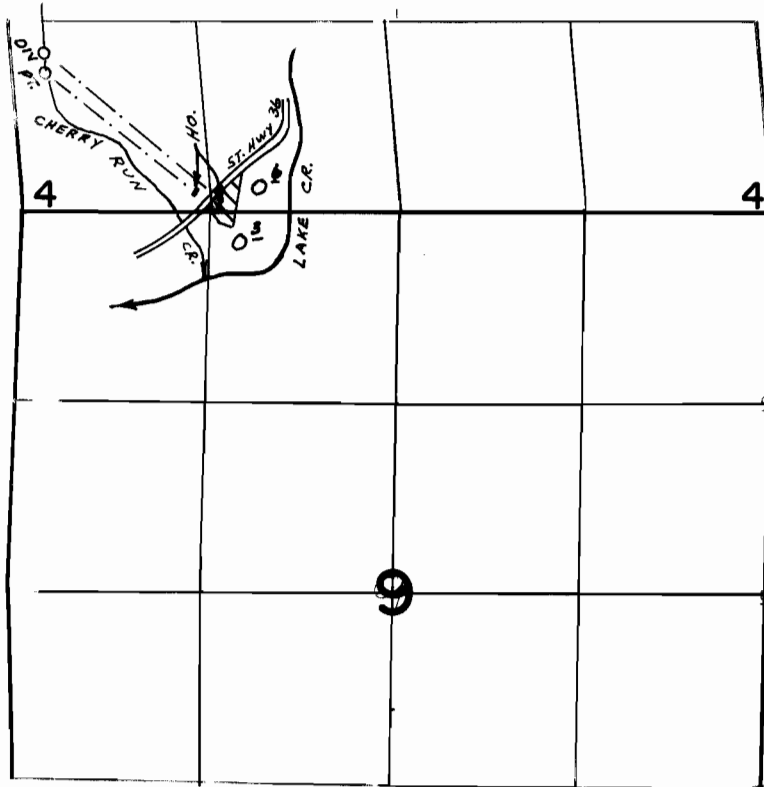

N. DIV. PT. - 1080' N. & 140' E., S. DIV. PT. - 950' N. & 150' E., BOTH FROM SW COR. SEC. 4

FINAL PROOF SURVEY
UNDER

Application No. 33938 Permit No. 26816
IN NAME OF

ALBERT & NELLIE WASSOM

Surveyed MAY 4 1976, by L.H. NUNN