

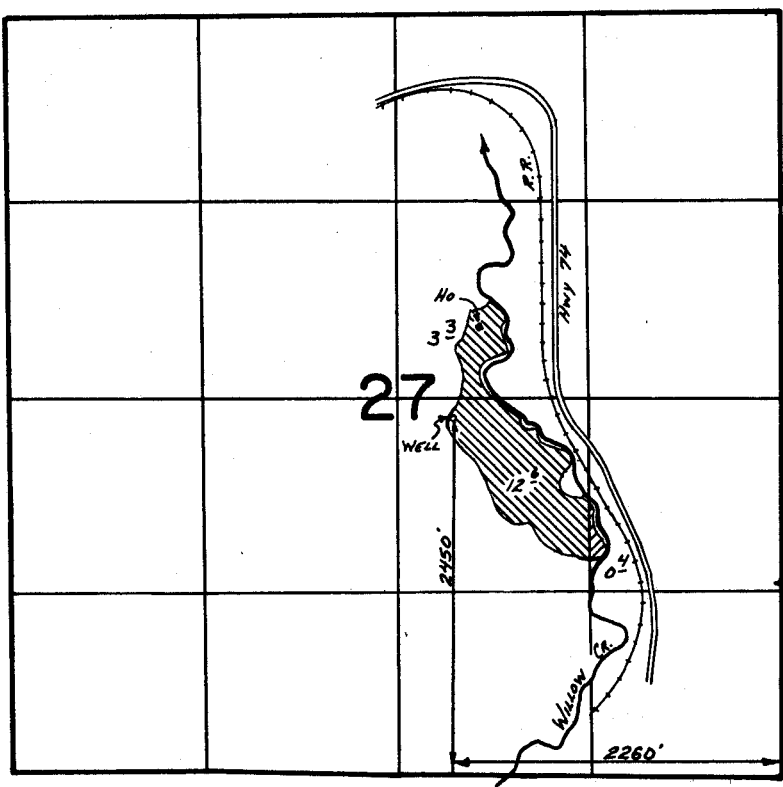

G 4445  
46914

# T.1N.,R.23E.,W.M.



Primary Irrigation -   
Supplemental Irrigation - 

## FINAL PROOF SURVEY UNDER

Application No. G-4723 Permit No. G-4445  
IN NAME OF

ROBERT HEIDEMAN

Surveyed July 23, 1976, by R. G. Mucken