

G 4972

46930

T. 4 N., R. 28 E., W. M.

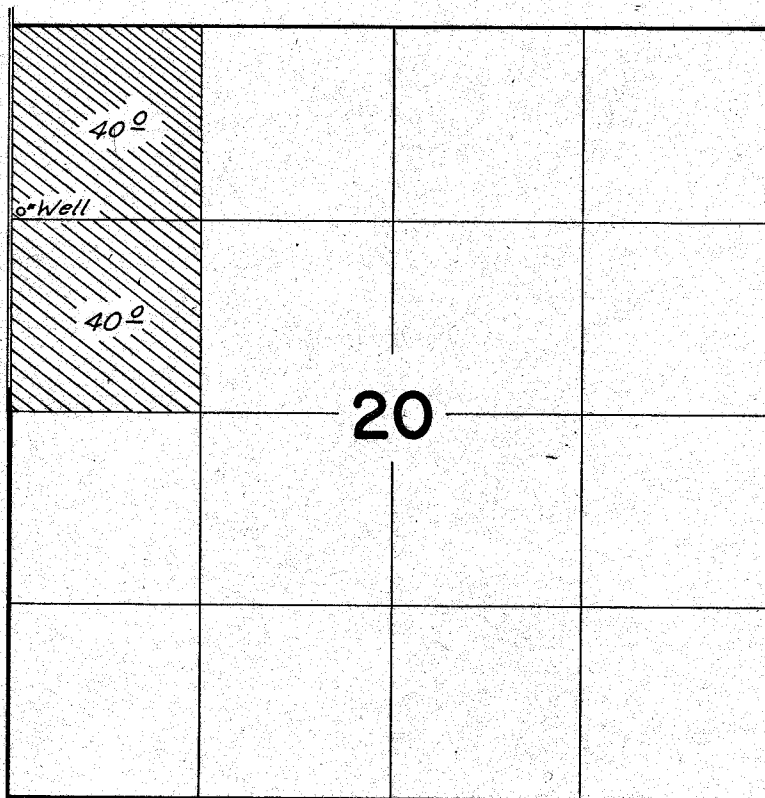

Well Loc.: 1260 ft. S., & 60 ft. E., from NW Cor. Sec. 20

FINAL PROOF SURVEY UNDER

Application No. G-5738 Permit No. G-4972
IN NAME OF

Lee & Lane Pollock

Surveyed Oct. 28, 1976, by L.H. Nunn