

T.24S.,R.11W.,W.M.

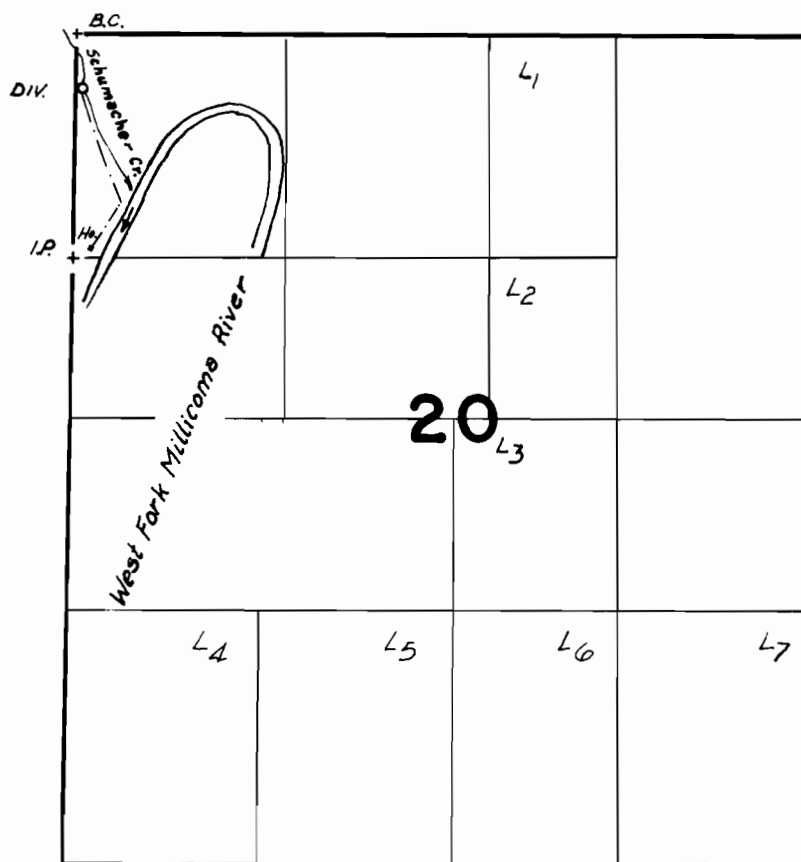

Div. Pt. Loc.: 400' S. & 50' E. from NW Cor. Sec. 20

FINAL PROOF SURVEY UNDER

Application No. 50788 Permit No. 38349
IN NAME OF

John L. & Clara P. Browning

Surveyed July 30, 1974, by L. Nunn

Insp. & COB-1HH-182 *ACB*