

G-6240
46978

T.38S.R.19E.W.M.

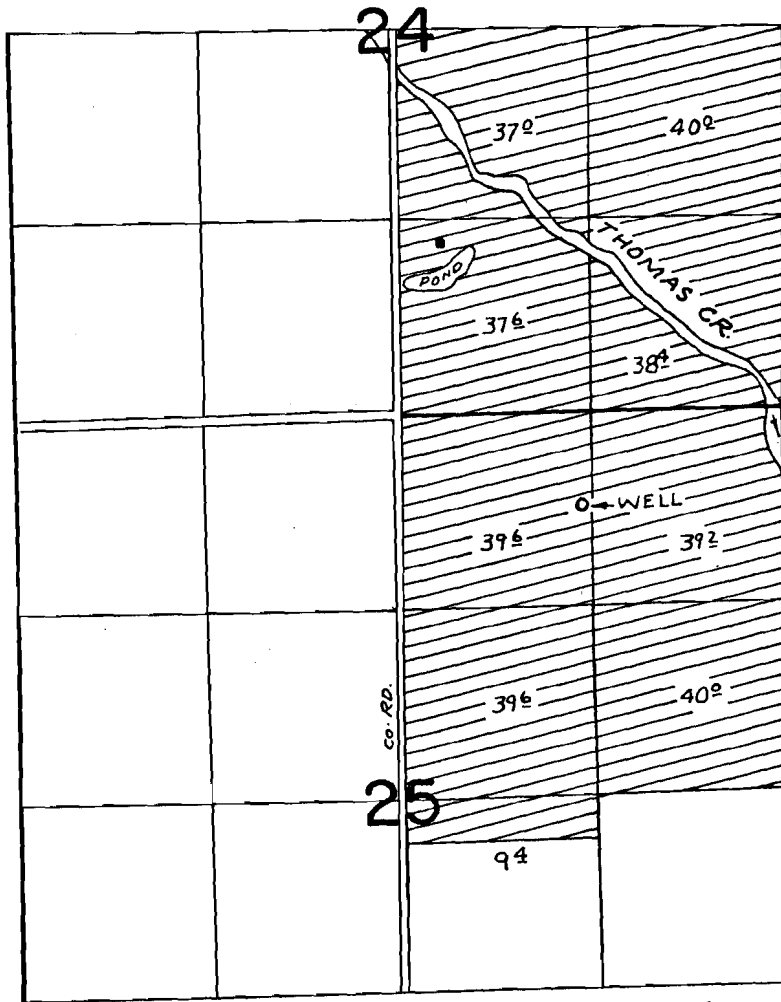

WELL LOC: 630' S. & 1260' E. FROM N 1/4 COR. SEC. 25

FINAL PROOF SURVEY UNDER

Application No. *G-6693*. Permit No. *G-6240*
IN NAME OF

JACK & VIRGINIA BRIDGMAN

Surveyed *OCT. 23 1976*, by *R. MUCKEN*

CH2-6KK-82