

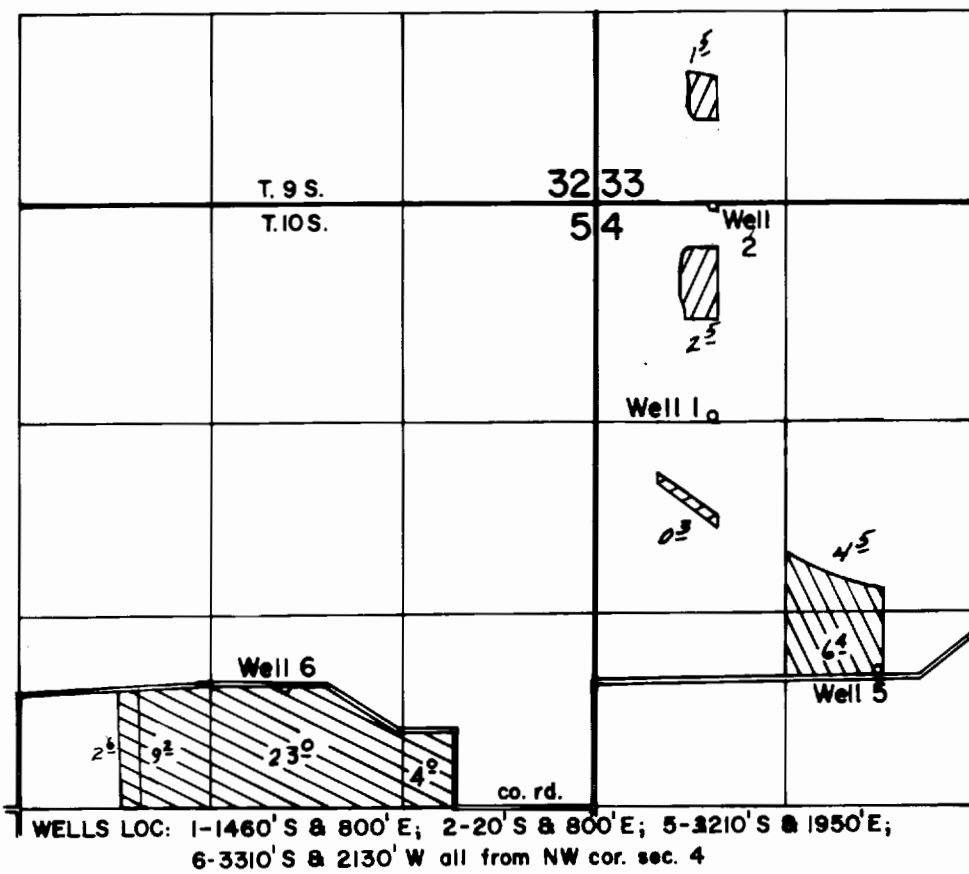



T.9&10S., R.3W., W.M.



-  Well 1
-  Well 2
-  Well 5
-  Well 6

FINAL PROOF SURVEY UNDER

Application No. G-5942 Permit No. G-5747
IN NAME OF

DEE S. & ROBERTA E. CHAMBERS

Surveyed April 15 1976, by D. Norby