

T. 1 N. R. 16 E. W. M.

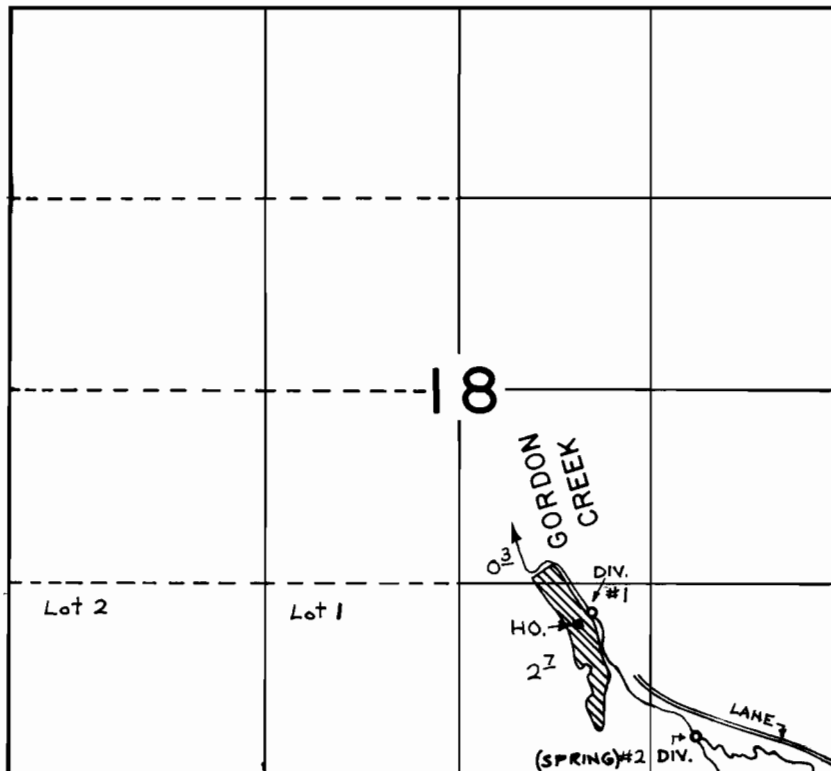

DIV. #1 LOC. - 1100' N. & 1700' W. FROM S.E. COR. SEC. 18
DIV. #2 LOC. - 250' N. & 1000' W. FROM S.E. COR. SEC. 18

FINAL PROOF SURVEY UNDER

Application No. 47571 Permit No. 35617
IN NAME OF

MALCOLM MCDERMID

Surveyed July 14 1976, by R.G. Mucken