

T. 3 S., R. 40 E., W.M.

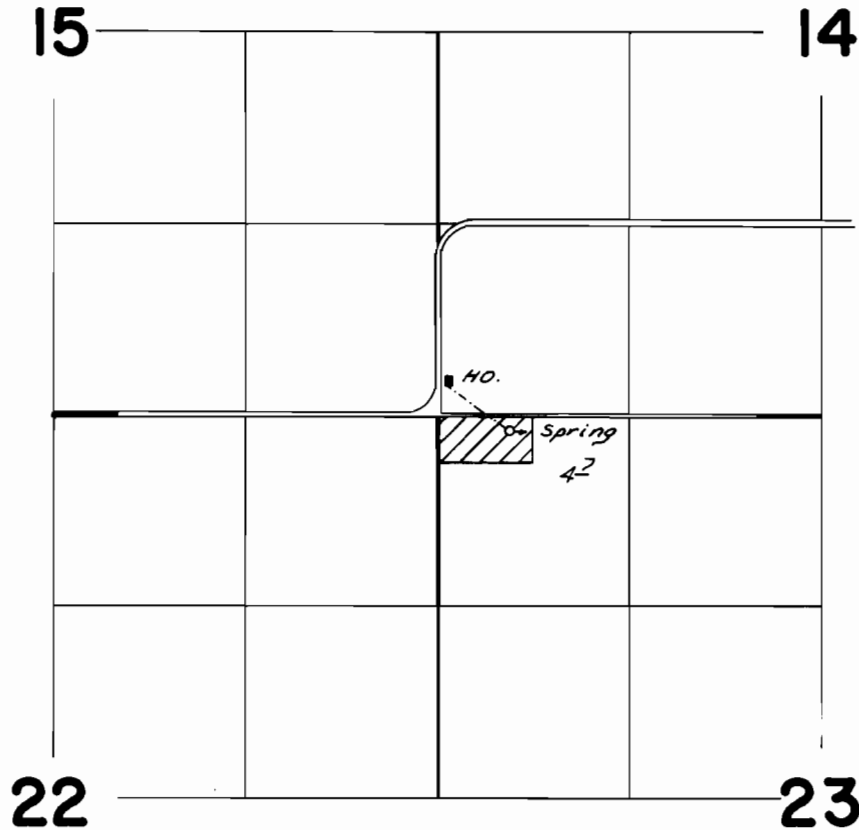

Spring Loc.: 90'S. & 510'E. from NW Cor. Sec. 23

FINAL PROOF SURVEY UNDER

Application No. 50124 Permit No. 37664
IN NAME OF

J. Eugene & Roella M. Scott

Surveyed Sept. 23, 1976, by D. M. Norby