

T.5S., R.7W., W.M.

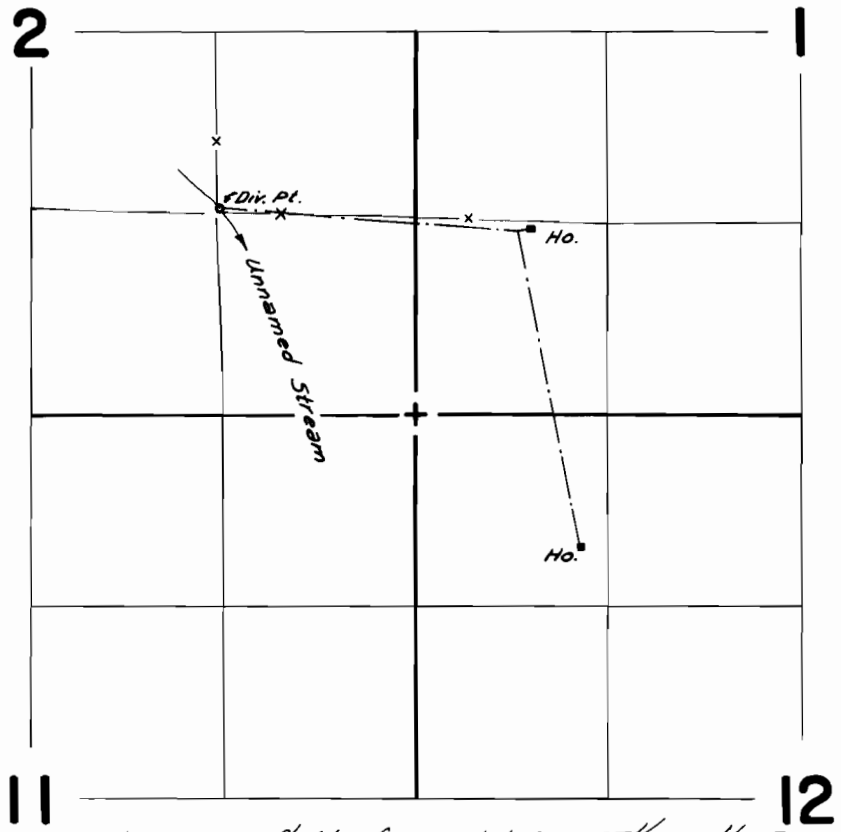

Div. Pt. Loc.: 10 ft. N. from NW. Cor. SE 1/4 SE 1/4 Sec 2

FINAL PROOF SURVEY UNDER

Application No. 49724 Permit No. 37239
IN NAME OF

Alton Basey & William O. Payne

Surveyed Sept. 9, 1976 by L.H.Nunn