

T. 4 S., R. 4 W., W.M.

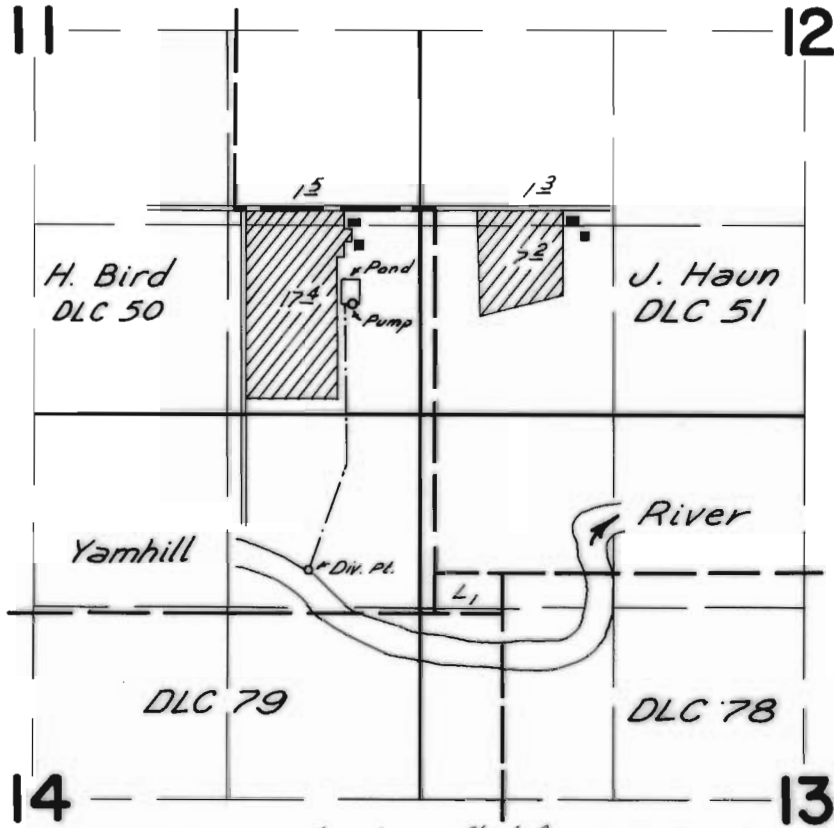

Div. Pt. Loc.: 1070 A.S. & 770 A.W. from NE Cor. Sec. 14.

FINAL PROOF SURVEY
UNDER

Application No. 50841 Permit No. 38386
IN NAME OF

Daryl Laune

Surveyed Apr 2, 1976 by L.H. Nunn