

T.5S., R.6W., W.M.

MADE INSPECTION OF THIS
30' X 30' MAP

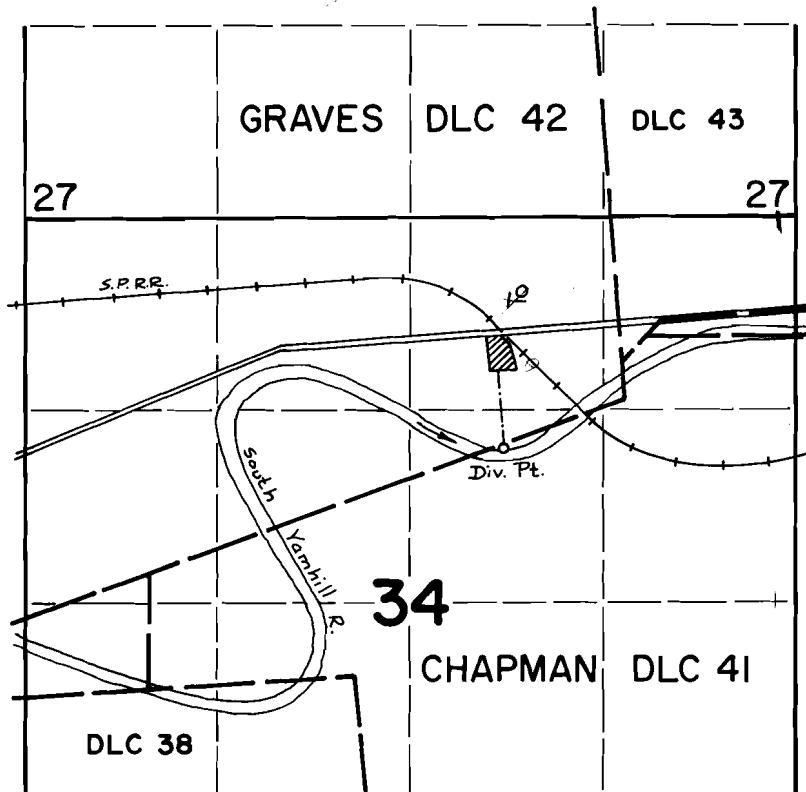

DIV. PT. LOC: 340' S & 820' W from SE cor. Graves DLC 42

FINAL PROOF SURVEY UNDER

Application No. 53343 Permit No. 39577
IN NAME OF

ALFRED M. & V. M. ANDERSON

Surveyed May 11 1976, by L.H. Nunn