

T.14S.R.8W.W.M.

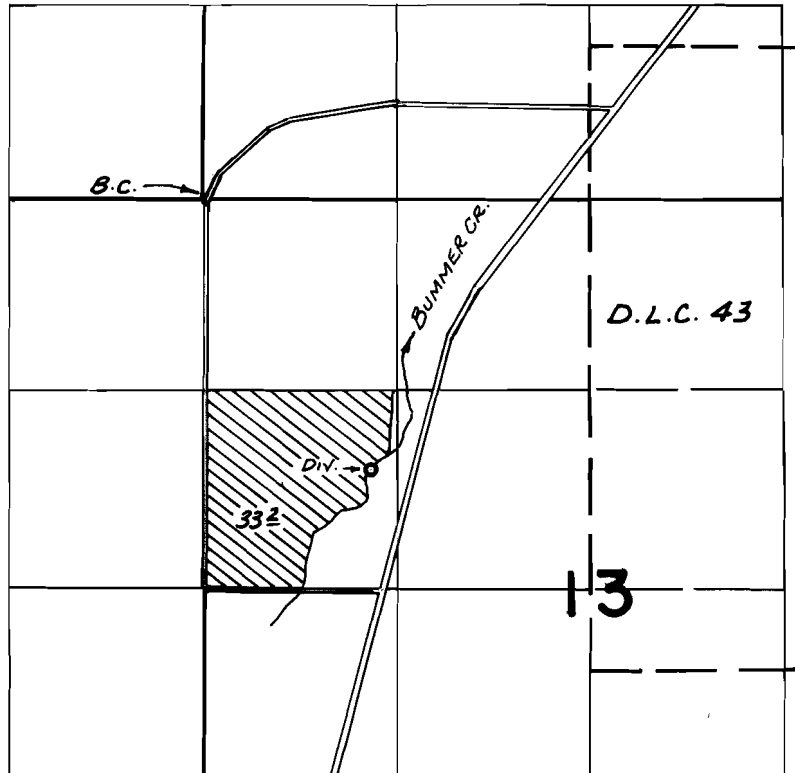

DIV. PT. LOC: 1860'S & 1130'E. FROM N.W. COR. SEC. 13

FINAL PROOF SURVEY UNDER

Application No. 50183 Permit No. 36793
IN NAME OF

FRED H. & ESTHER CALLAHAN

Surveyed SEPT. 20 1977, by B.O.B. BARWIN