

T.7S. R.3W. W.M.

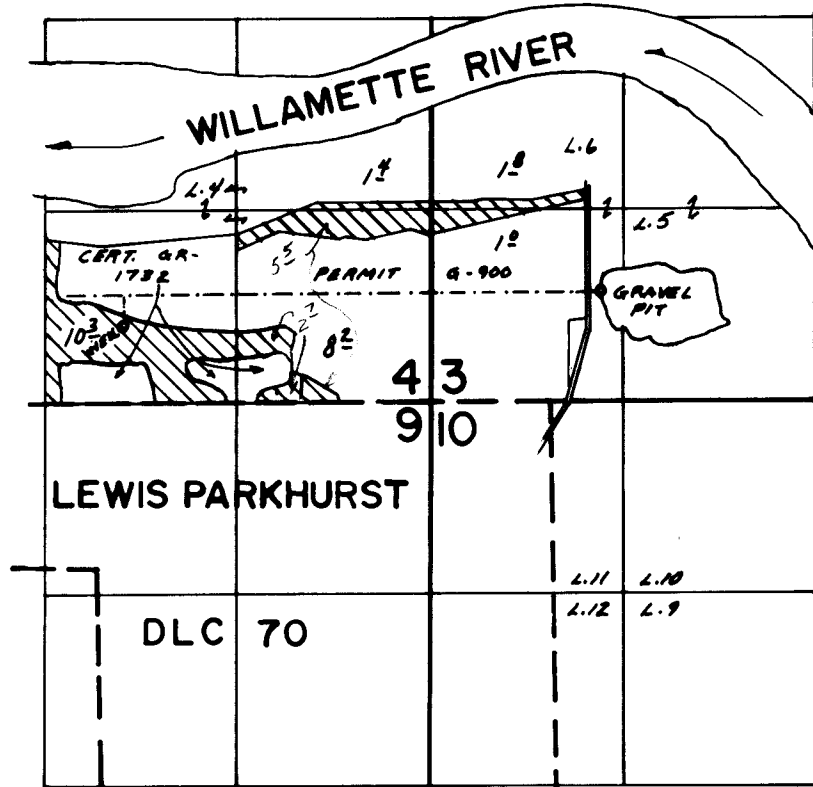

PIT WELL LOC. - 700' N & 350' E FROM NE COR. PARKHURST DLC TO
 WELL LOC. - 520' N & 530' E. FROM S 1/4 COR. SEC. 4

FINAL PROOF SURVEY UNDER

Application No. G-6481 Permit No. G-6103
 IN NAME OF

RIVERKAIID FARMS, INC.

Surveyed June 9, 1976, by R. G. Mucken