

T. 1 S. R. 9 W. W. M.

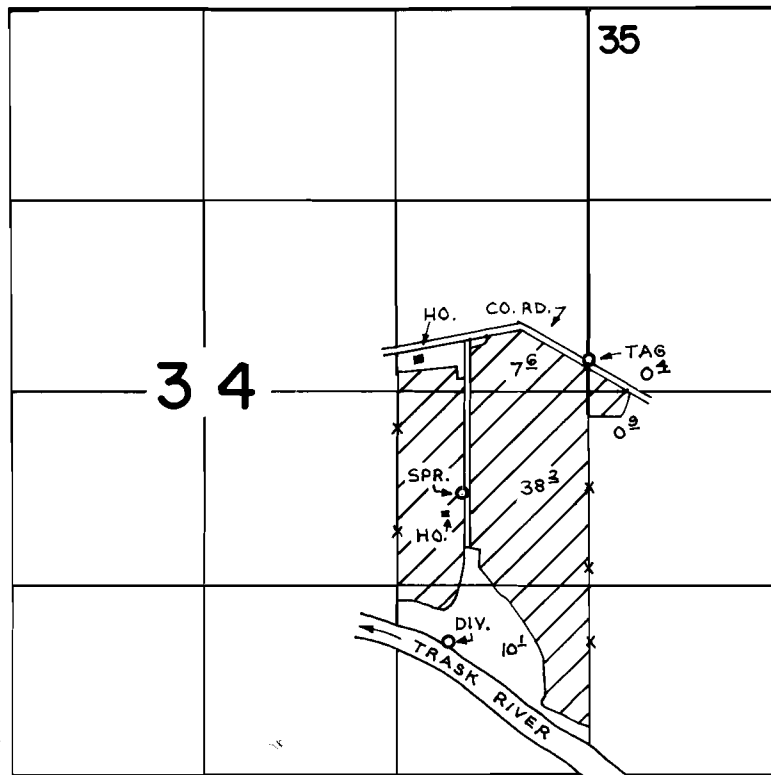

SPRING LOC. - 700' S. & 870' W. FROM N.E. COR. NE. 1/4 S.E. 1/4 SEC. 34
DIV. LOC. - 1720' S. & 960' W. FROM N.E. COR. NE. 1/4 S.E. 1/4 SEC. 34

FINAL PROOF SURVEY
UNDER

Application No. 48353 Permit No. 36306
IN NAME OF

ROBERT HANCE LARSON

Surveyed July 26 1976, by R.G. Mucken