

T.2S.R.44E.W.M.

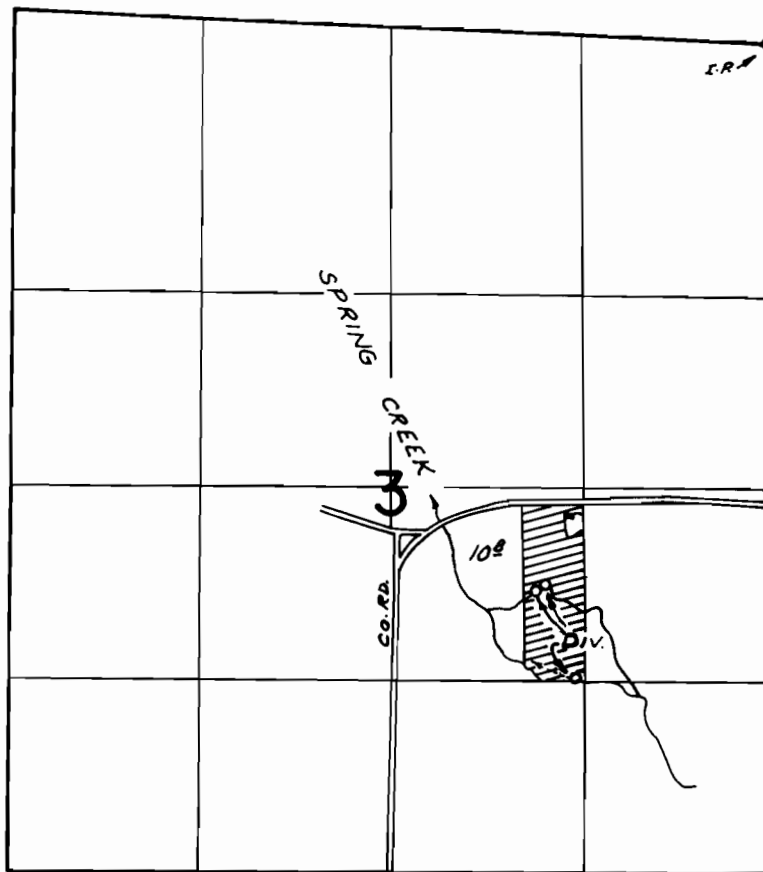

DIV. PTS. LOC: 10' N & 70' W; 620' N. & 330' W; 670' N. & 270' W, ALL
FROM S.E. COR. N.W. 1/4 S.E. 1/4 SEC. 3

FINAL PROOF SURVEY
UNDER

Application No. 50799 Permit No. 39359
IN NAME OF

OTIS M. FISCHER

Surveyed SEPT. 23 1976, by R. MUCKEN