

T. 15. R. 45 E. W. M.

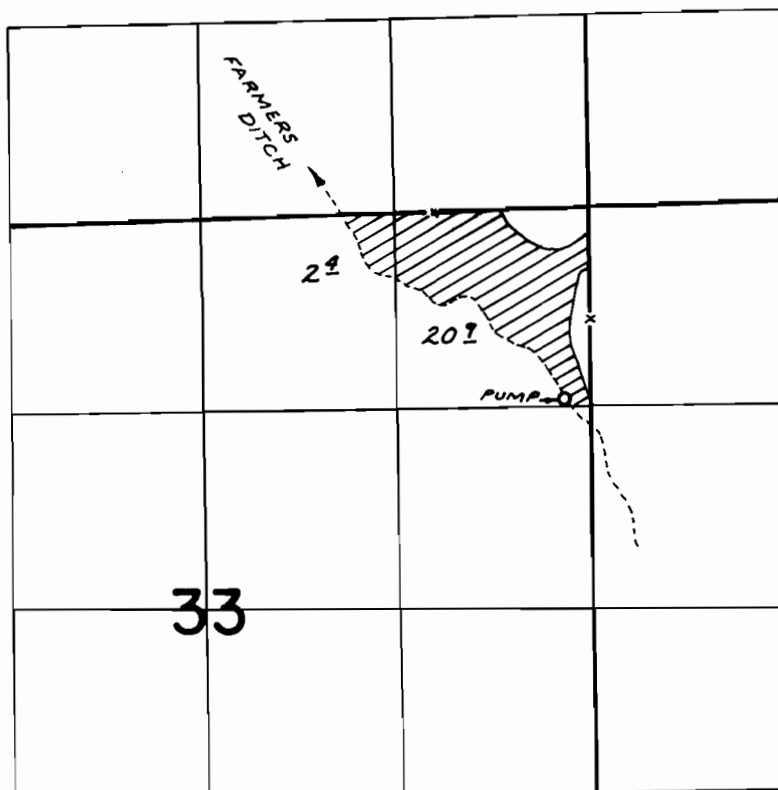

DIV. LOC: 624' S77°20'E. FROM N.W. COR. SEC. 5. T. 35. R. 45 E.

FINAL PROOF SURVEY UNDER

Application No. 53796 Permit No. 40165
IN NAME OF

NORMAN L. PRAIT

Surveyed SEPT. 28 1976, by R. MUCKEN.