

T.4S.,R.5W.,W.M.

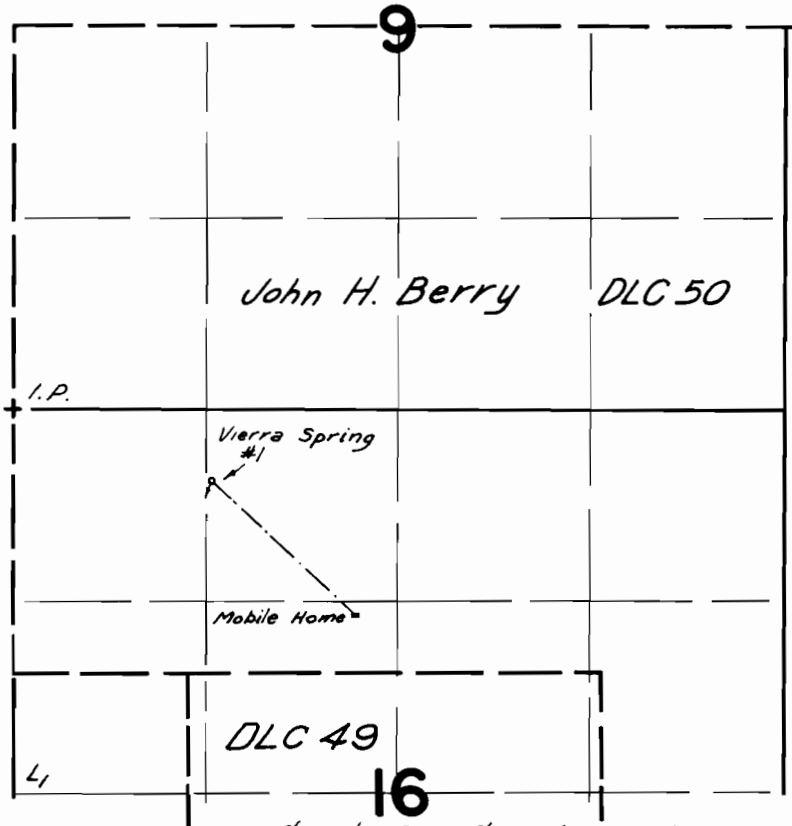

Spring Loc.: 480 ft. S. & 1360 ft. E. from NW Cor. Sec. 16

FINAL PROOF SURVEY UNDER

Application No. 52409 Permit No. 38562
IN NAME OF

Jerry Garris

Surveyed Oct. 15, 1976, by L. H. Nunn