

T.28&3S., R.5W., W.M.

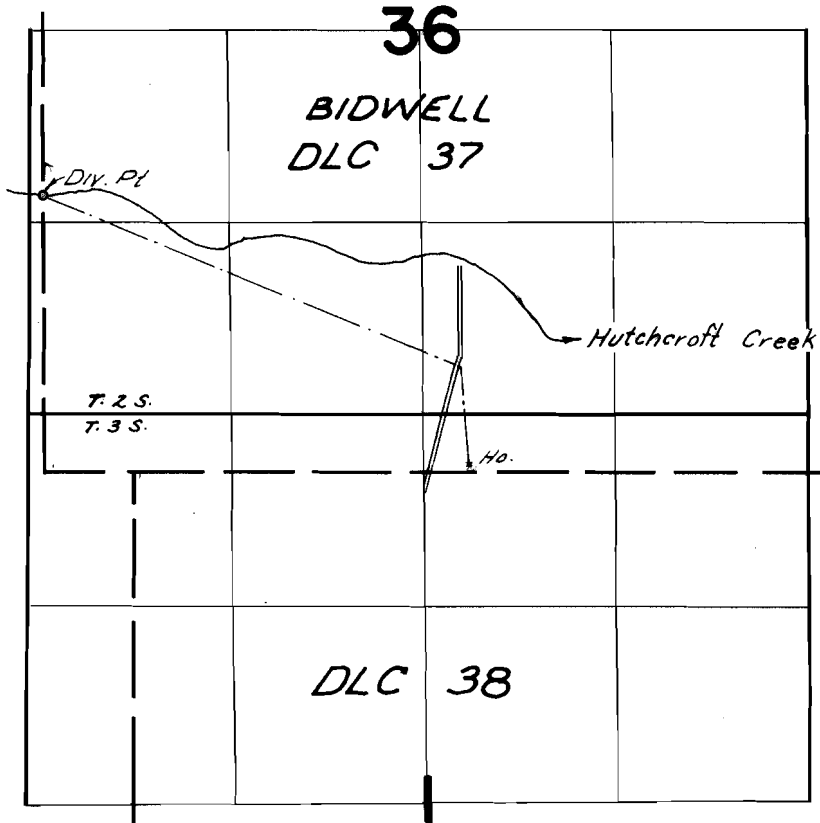

Div. Pt. Loc.: 1920 A.N. from SW Cor DLC 37

FINAL PROOF SURVEY
UNDER

Application No. 53787 Permit No. 40159

IN NAME OF

Kenneth J. Whitlow

Surveyed Aug 2, 1976, by L. H. Nunn