

T.4S.,R.IW.,W.M.

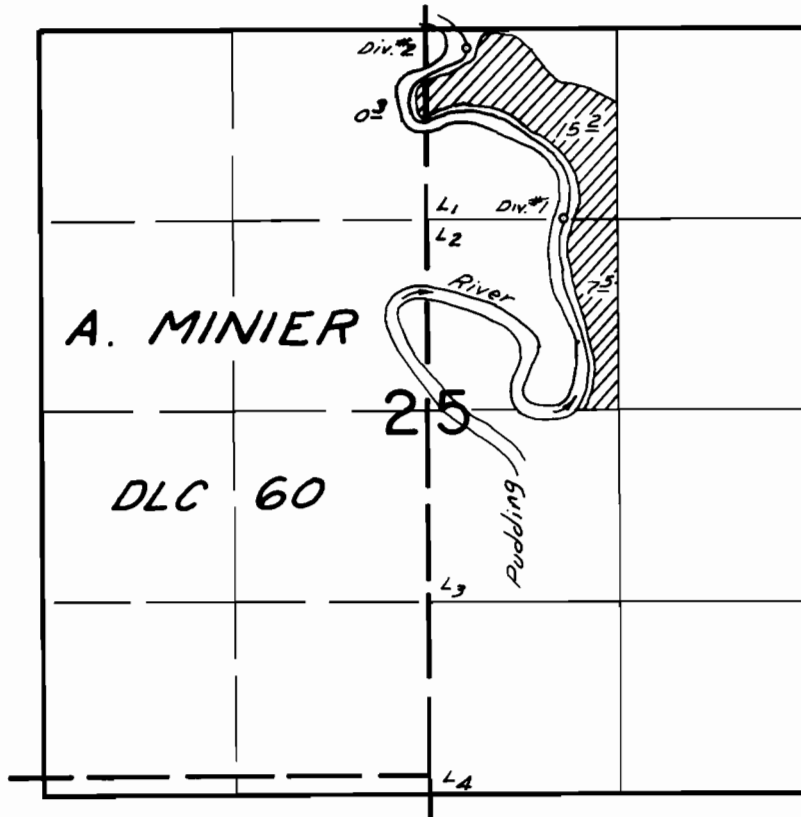

Div. Pts. Loc.: #1-1310'S., § 1690'W.; #2-140'S., § 2340'W.;
Both from NE. cor. Sec. 25

FINAL PROOF SURVEY UNDER

Application No. 52873 Permit No. 39901
IN NAME OF

Claude L. Pintok

Surveyed Aug 3, 1977, by JL Brown