

T. 3 S., R. 2 E., W.M.

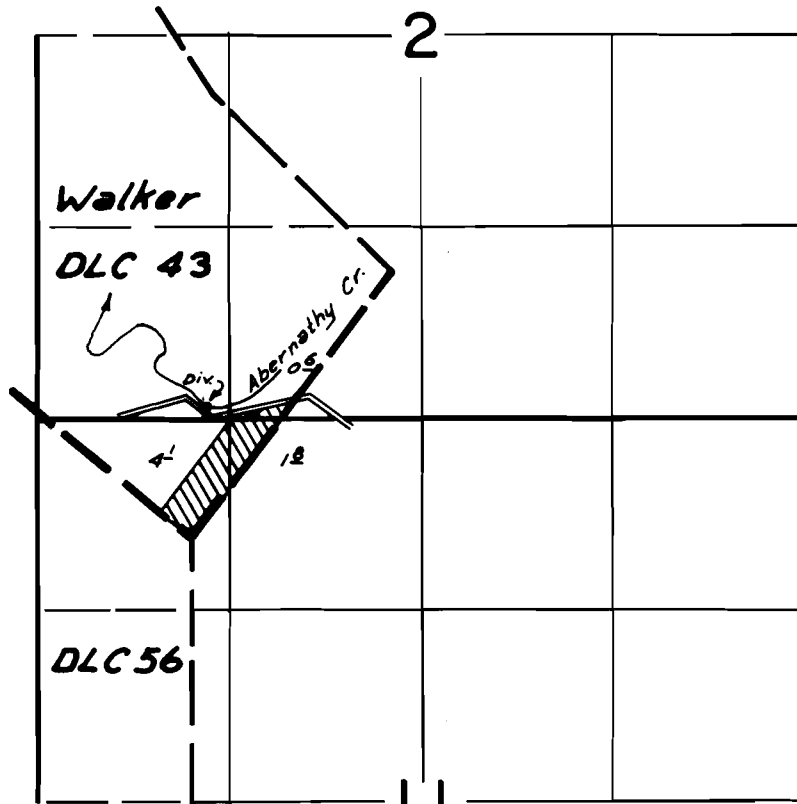

Div. Pt. Loc.: 910 ft N. & 110 ft E. from SE Cor. Walker
DLC 43

FINAL PROOF SURVEY UNDER

Application No. 52967 Permit No. 37806
IN NAME OF

Maynard D. Williams

Surveyed Aug 3, 1977, by H. Brown