

T.9&10S., R.3W., W.M.

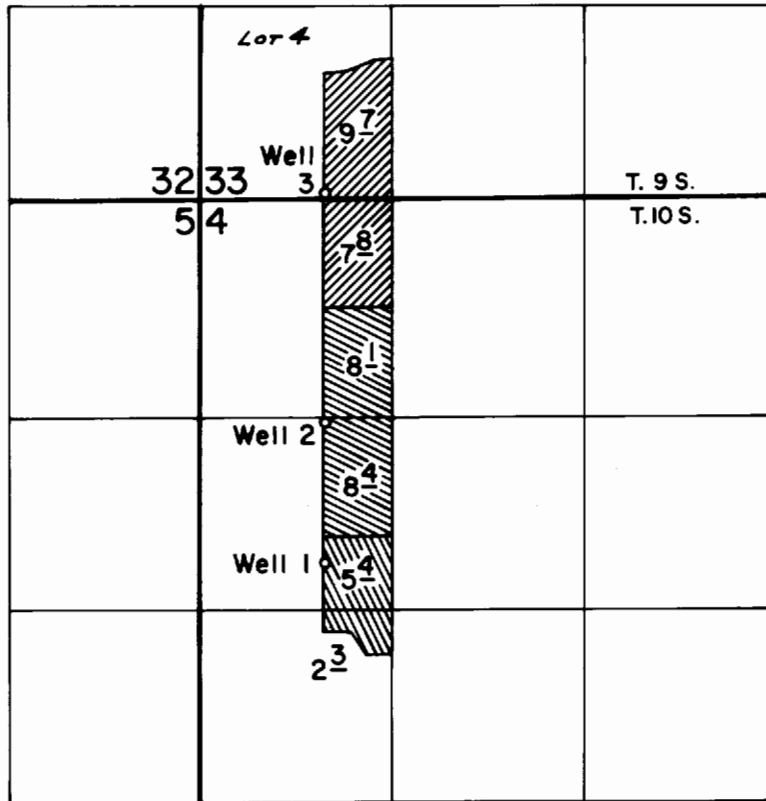

WELLS LOC: 1-2500' S & 860' E; 2-1530' S & 860' E; 3-30' N & 860' E all from NW cor. sec. 4



FINAL PROOF SURVEY UNDER

Application No. G-6008 Permit No. G-5676
IN NAME OF

LYNN A. & CLAUDIA J. HOEFER

Surveyed April 12 1976, by D. Norby