

G-5148
G-6285
74467
47197
74468
47198

T. 4 N., R. 29 E., W.M.

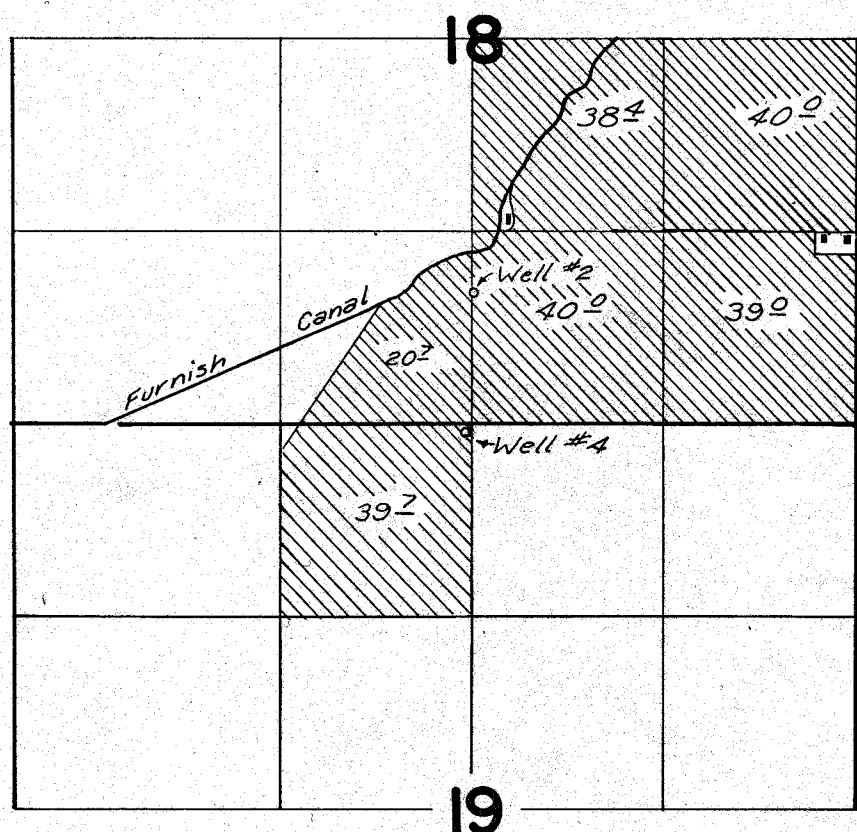

Wells Loc.: #2, - 1730 ft S. & 20 ft E.,
from Ctr. Sec. 18; #4 - 50 ft S. & 40 ft
W. from N. 1/4 Cor. Sec. 19

FINAL PROOF SURVEY UNDER

Application No. G-5387 Permit No. G-5148
G-6765 G-6285

IN NAME OF

Glenn S. Chowning

Surveyed July 31, 1976 by L. H. Nunn