

G-5148

G-6285

74467  
47197  
74468  
47198

# T. 4 N., R. 29 E., W.M.

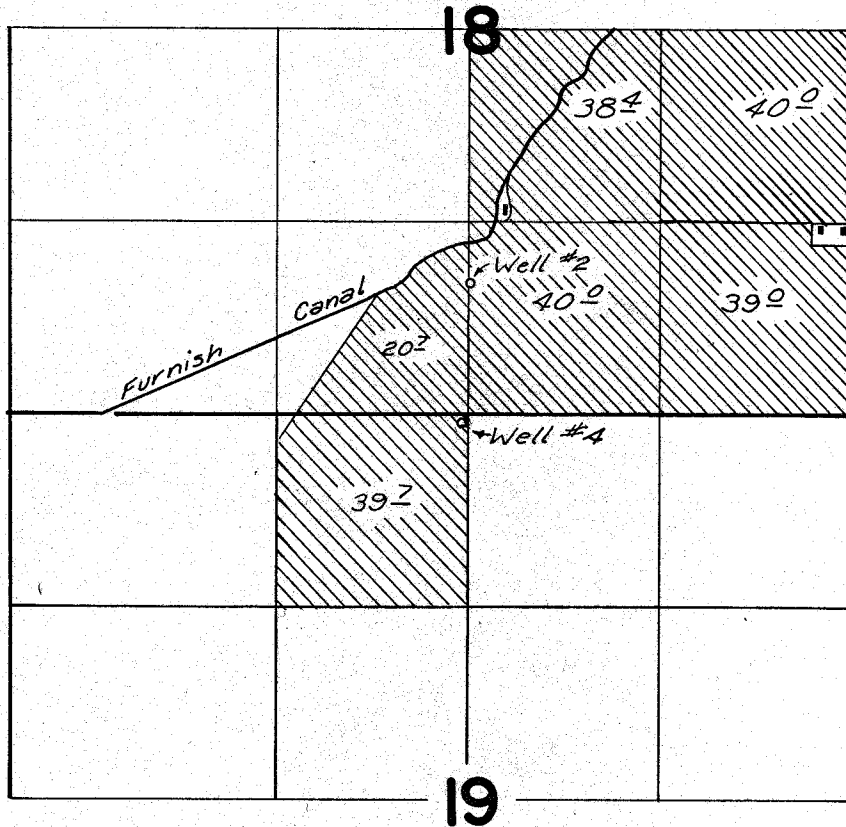

Wells Loc.: #2, - 1730 ft S. & 20 ft E.,  
 from Ctr. Sec. 18; #4 - 50 ft S. & 40 ft.  
 W. from N. 1/4 Cor. Sec. 19

## FINAL PROOF SURVEY UNDER

Application No. G-5387 Permit No. G-5148  
G-6765 G-6285  
 IN NAME OF

Glenn S. Chowning

Surveyed July 31, 1976, by L.H. Nunn.