

T.2S.R.44E.W.M.

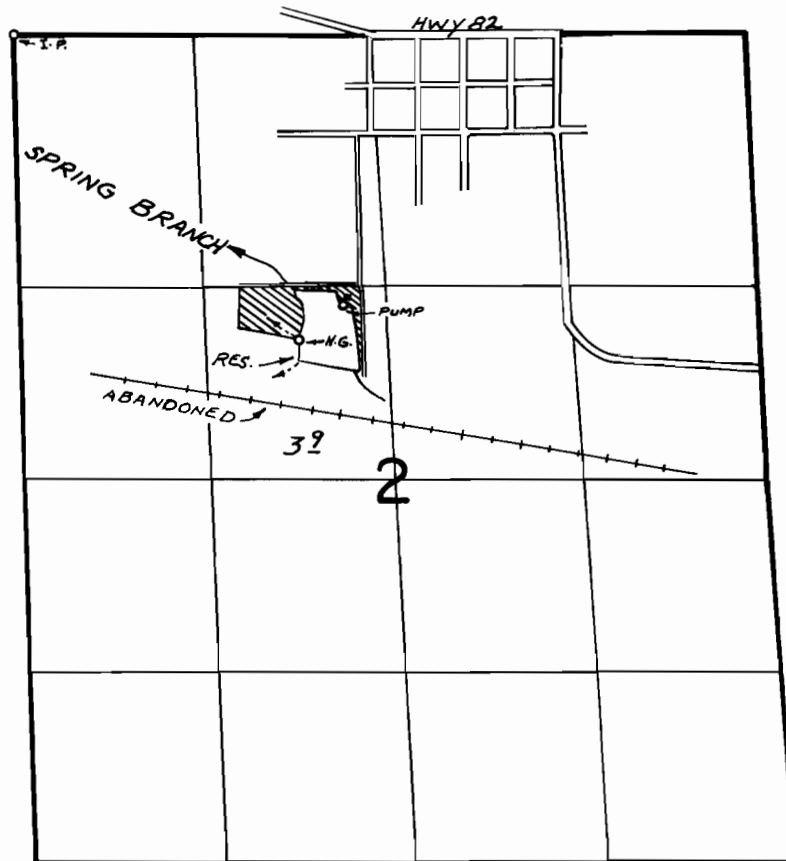

DIV. LOC: 30'S. & 620'W. FROM NE. COR. SE $\frac{1}{4}$ NW $\frac{1}{4}$ SEC. 2
SPRINGS ARE LOC. ALONG E. EDGE OF RES. BOTTOM

FINAL PROOF SURVEY UNDER

Application No. R-49872 49873 Permit No. R-5998 36748
IN NAME OF

FORD PETERSON

Surveyed SEPT. 22 1976, by R. MUGKEN