

# T.2S.R.44E.W.M.

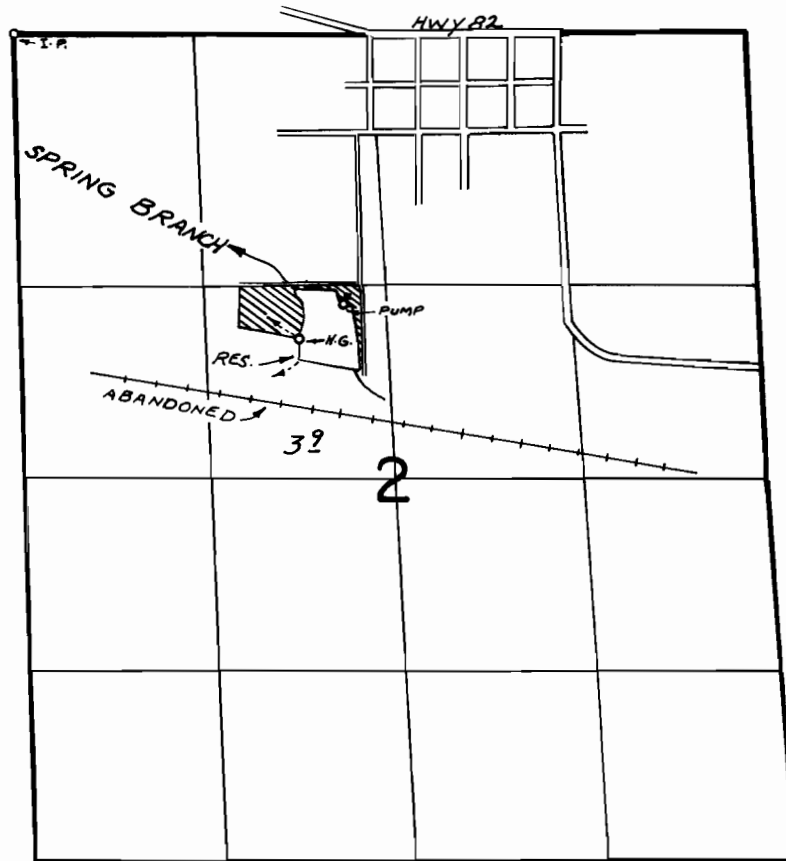

DIV. LOC: 30'S. & 620'W. FROM NE. COR. SE  $\frac{1}{4}$  NW  $\frac{1}{4}$  SEC. 2  
SPRINGS ARE LOC. ALONG E. EDGE OF RES. BOTTOM

## FINAL PROOF SURVEY UNDER

Application No. R-49872 Permit No. R-5998  
49872 36248  
IN NAME OF

.....FORD PETERSON.....

Surveyed SEPT. 22 1976, by R. MUCKEN