

P# 37496

T. 2 N. R. 12 E. W. M.
NW NW SEC 12

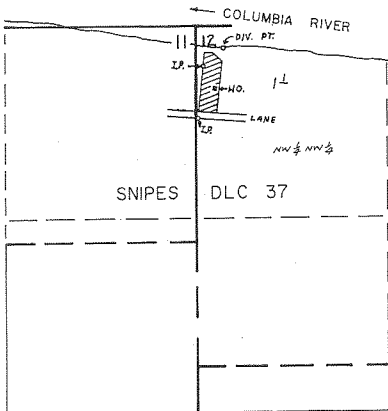

DIV. PT. LOC. 150' S. & 190' E. FROM N.W. COR. SEC. 12
SCALE: 1" = 660'

FINAL PROOF SURVEY
UNDER

Application No. 50192..... Permit No. 37496...
IN NAME OF

RICHARD M. & MILDRED A. GRIFFIN.

Surveyed JUN. 29. 1977, by R. G. MUCKEN.....