

T.2S. R.3W. W. M.

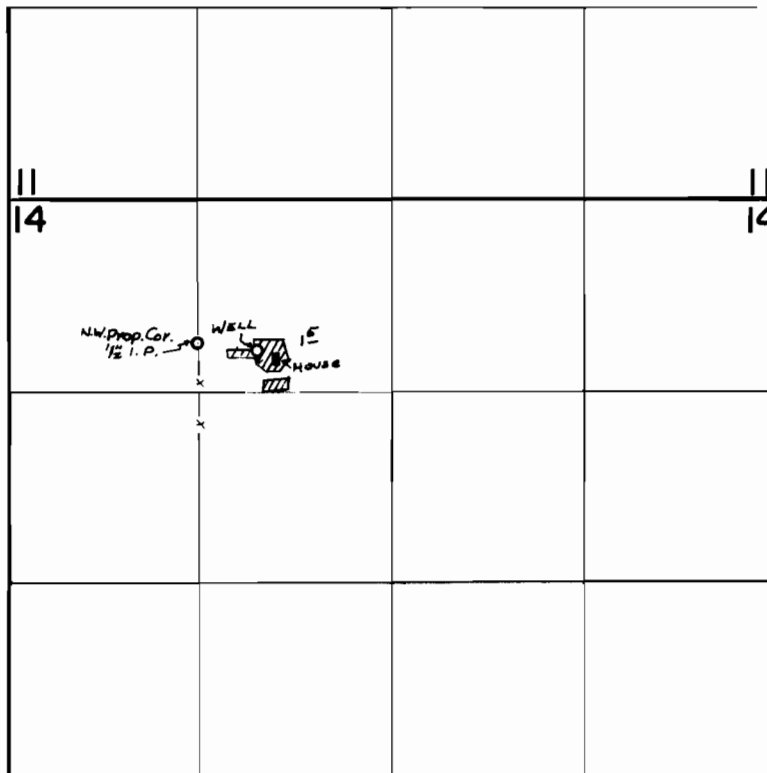

Well Loc. 1020' S. & 940' W. from N 1/4 Cor. Sec. 14

FINAL PROOF SURVEY
UNDER

Application No. G-7123 Permit No. G-6695
IN NAME OF

STANLEY W. & SANDRA B. BEERLI

Surveyed Oct. 6, 1977, by J.S. Donaldson