

T.2N.R.5W.W.M.

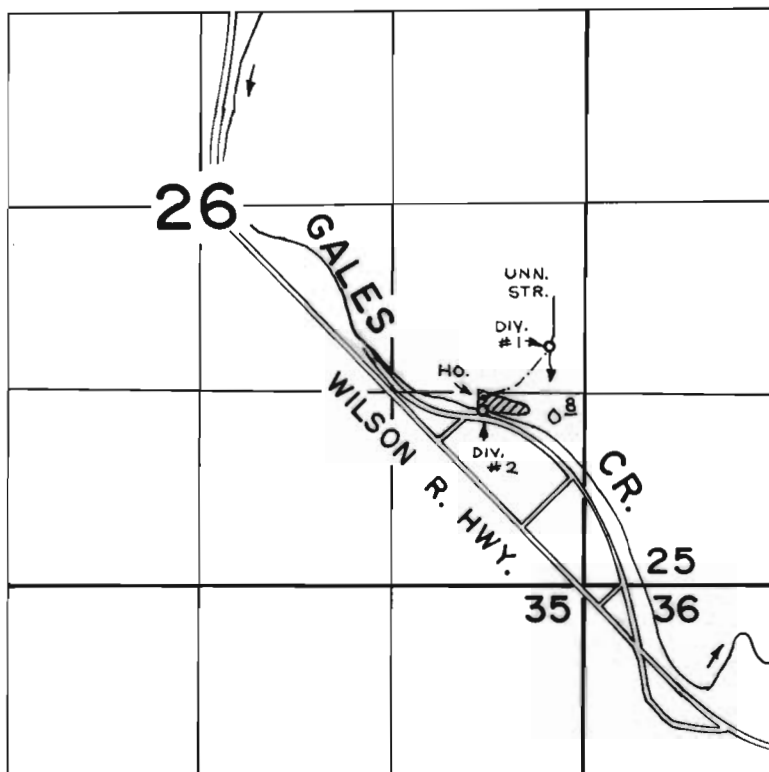

DIV. #1 - 300' N. & 240' W., #2 - 120' S. & 680' W. BOTH FROM N.E. COR. S.E. 1/4 SE. 1/4 SEC. 26

**FINAL PROOF SURVEY**  
UNDER

Application No. **47506** Permit No. **35581**  
IN NAME OF

**HOMER G. & ANITA B. BAINBRIDGE**

Surveyed May 17, 1976, by R. G. Mucken