

DITCH

NW 1/4 SW 1/4

TIE 470' S 48° E

POINT OF DIVERSION #1

SUMP - SECONDARY SOURCE

TIE 520' S 41° E

WATER RIGHT MAP

FOR: VERNON E. DUYCK  
RT. 1, BOX 370  
FOREST GROVE, OREGON

T 1 N, R 3 W, W. M.

SECTIONS 18 & 19



SW 1/4 SW 1/4

SE 1/4 SW 1/4

RECEIVED  
JAN 21 1972  
STATE ENGINEER  
SALEM, OREGON

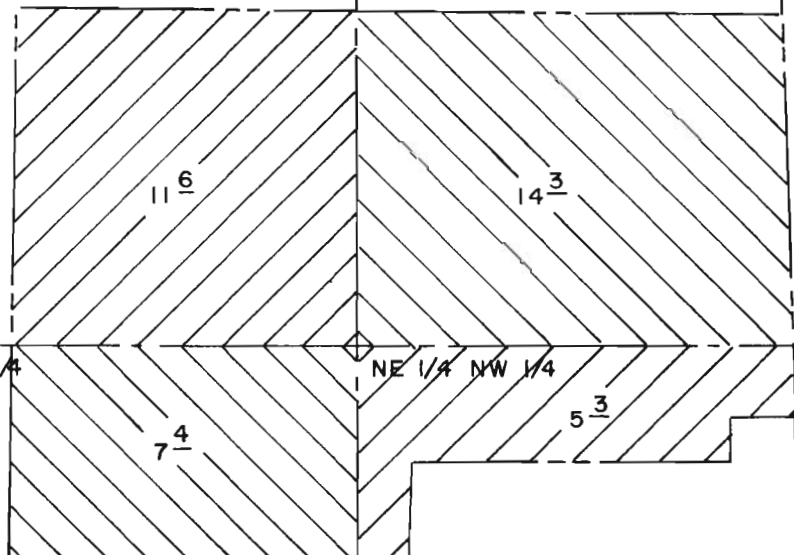

13 18  
24 19

NW 1/4 NW 1/4

NE 1/4 NW 1/4

KEMPER ROAD

RECEIVED  
DEC 13 1971  
STATE ENGINEER  
SALEM, OREGON

Application No. 48893  
Permit No. 36747

PREPARED BY P.G.E. CO.

SCALE: 1" = 400 FT.