

T.2N.R.5W.W.M.

1"=660'

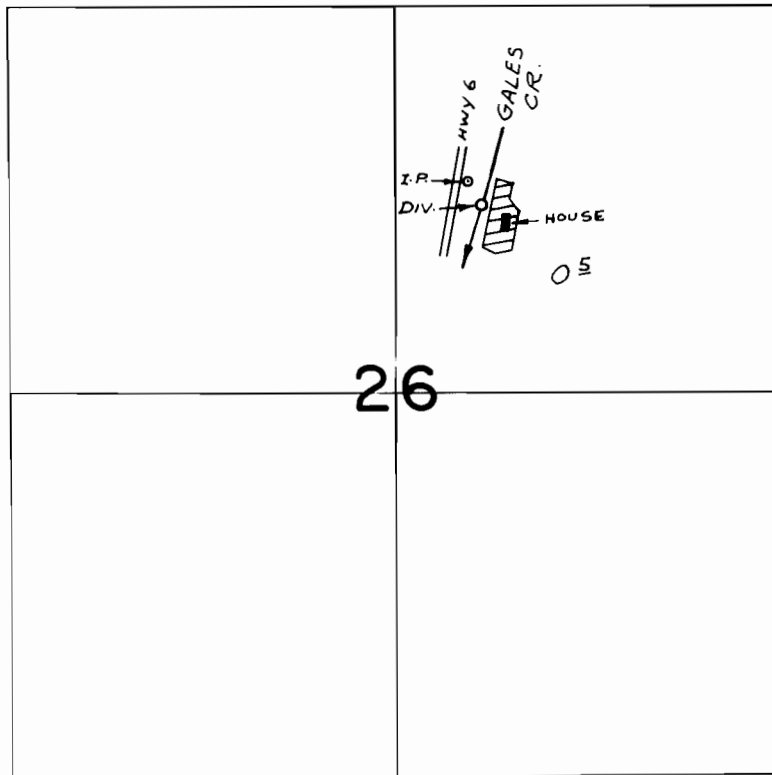

DIV. LOC: 680'S. & 300'E. FROM N.W. COR. S.W. ¼ NE ¼ SEC. 26

FINAL PROOF SURVEY
UNDER

Application No. 52067 Permit No. 39237
IN NAME OF

ELMER R. CRUME

Surveyed MAY 17, 1976, by R. MUCKEN