

# T. 1N. R. 4W. W.M.

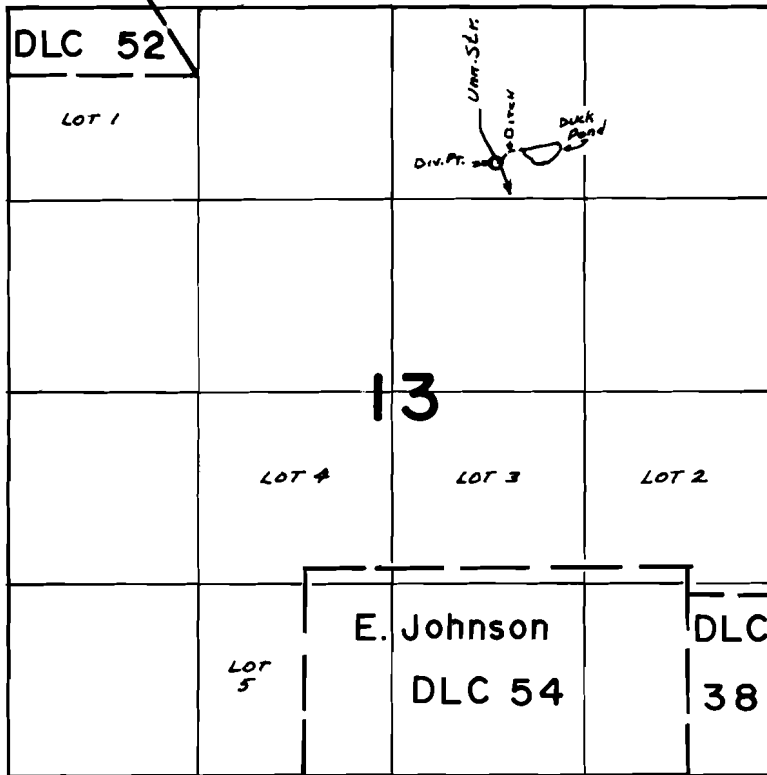

*DIV. PTS. LOC: STREAM - 1060' S. & 1920' W ; RES. - 1000' S. & 1600' W., BOTH FROM N.E. COR. SEC. 13*

## FINAL PROOF SURVEY UNDER

R-54256                      R-6477  
 Application No. 54257 Permit No. 40591  
 IN NAME OF

.....HENRY BAUM, JR.....

Surveyed Oct. 25 1977, by S.C. BROWN.